



CTF

Countertop Freezer & Ice Cream Freezer

500 S. Falkenburg Road
Suite 200 | Tampa, FL 33619
800.441.4014 | 813.870.0340
www.excellenceindustries.com

The company reserves the right to change the design and/or specifications of these products without notice. Printed in the USA.
Current version 8.19

KEY ASPECTS

SPECIAL FEATURES:

- 3 adjustable shelves (CTF-3HC)
- 2 adjustable shelves (CTF-2HC)
- Right hinge self closing door
- Environmentally friendly hydrocarbon refrigerant

OPTIONS:

- Lighted door graphic
- Graphics
- Left hinge units



Optional lighted door graphic



Double Combo-MCT-4HC with 2 optional CTF-3HC



Combo MCT-2HC with one optional CTF-3HC



Complies with 2017 DOE standards for commercial freezer and ice cream freezer

TECHNICAL SUMMARY

MODEL	SIZE				ELECTRICAL		REFRIGERATION			OTHER	
	Dimensions (inches)* Width x Depth x Height	Cubic Feet	Net Weight (lbs.)	Shipping Weight (lbs.)**	Voltage/Hz/Phase	Running Amps	Compressor HP	Refrigerant	Temperature	No. of Optional Baskets	Container Quantity
CTF-2HC	22 1/2 x 20 7/8 x 21 3/8	1.9	76	84	115/60/1	2.1	1/4	R-290	-15°F to +15°F	2	304
CTF-3HC	24 x 21 1/8 x 27 1/8	3.4	95	103	115/60/1	3.6	2/5	R-290	-15°F to +15°F	3	171

*Dimensions are all nominal lengths

**Does not include weight of pallets when needed



CTF-2HC

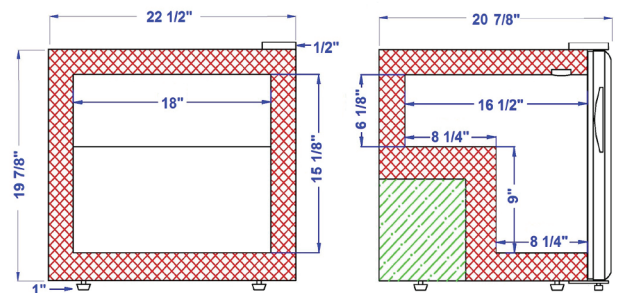

CTF-3HC

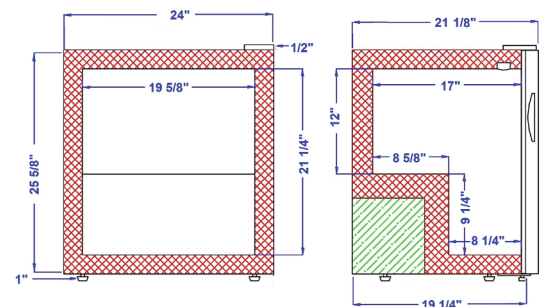

500 S. Falkenburg Road
Suite 200 | Tampa, FL 33619
800.441.4014 | 813.870.0340
www.excellenceindustries.com
ver. 8.19