

MOTAK

Glass Door Merchandiser

Model #: MGD-3DR-80-X

Product Details

- Eco-friendly R290 refrigerant
- Double-pane glass doors with positive-seal closures
- Efficient LED interior lighting
- Exterior: black
- Interior: aluminum liner with stainless steel floor
- High-density insulation
- Electronic control system makes it easy to adjust temperature set point and defrost frequency
- Adjustable heavy-duty coated shelves
- Temperature range: 33°F - 41°F
- Easy-to-access condenser coil
- 3" pre-installed swivel casters

Not suitable for installation in non-commercial or residential applications.



Warranty

2 years parts & labor and additional 3 years on compressor

Certifications



Plan View

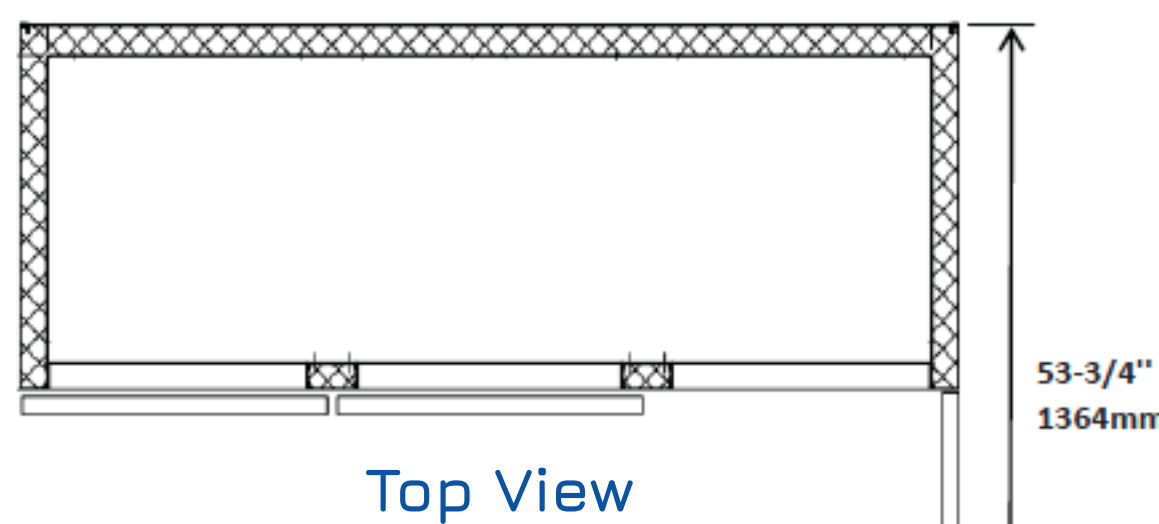

Top View

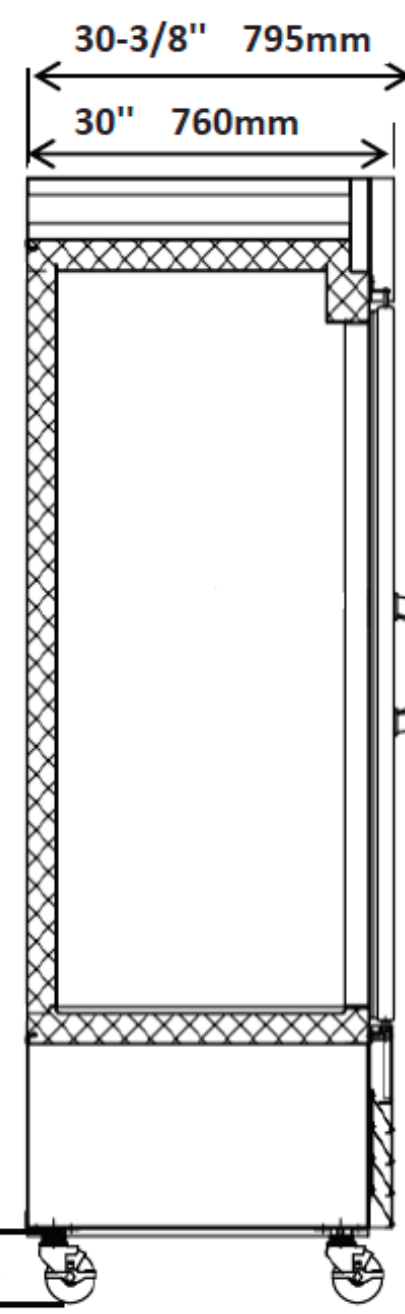

Side View

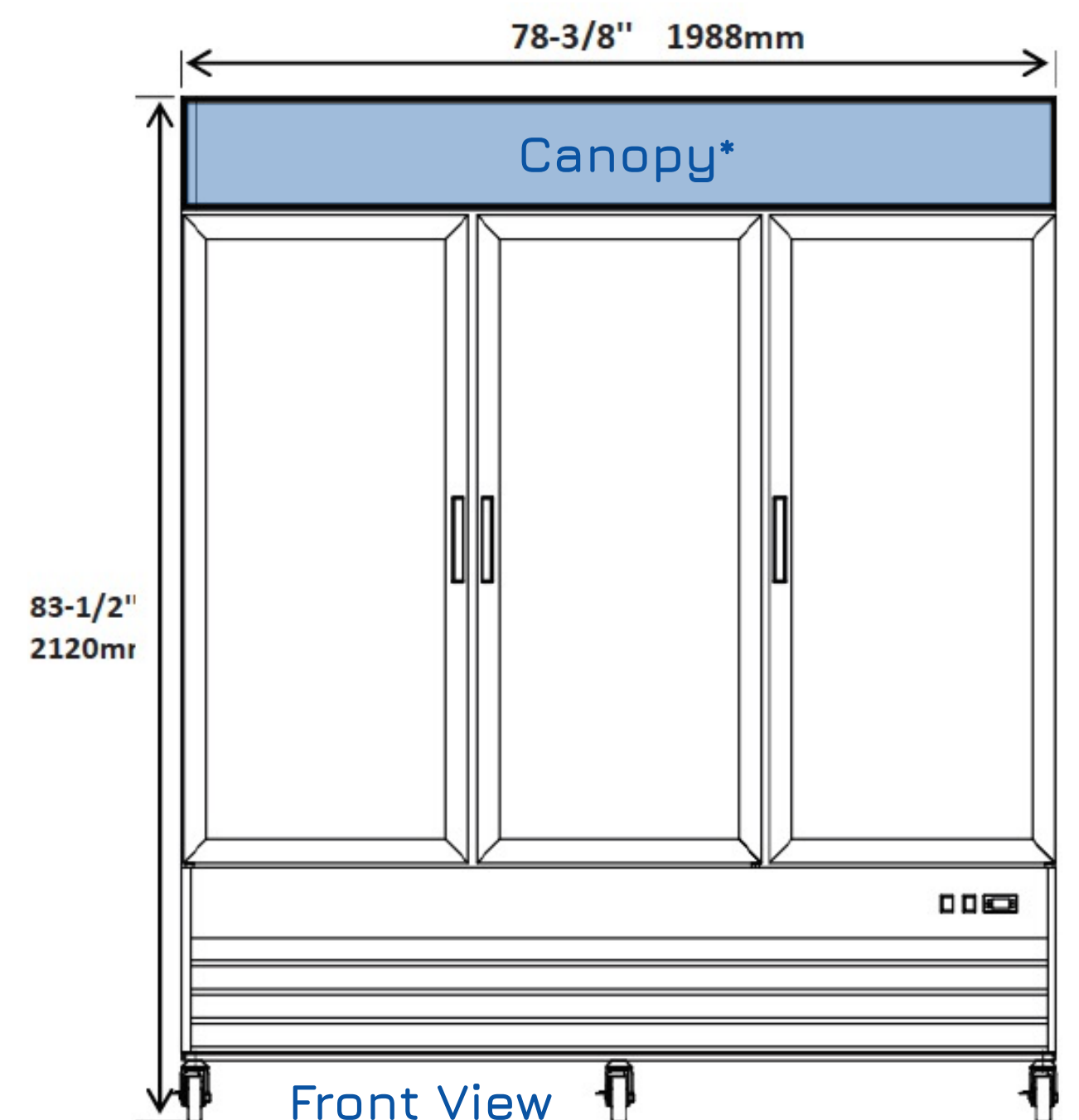

Front View

Specifications

| Model | Doors | Shelves | Canopy* Dims (in) | | Cabinet Dims (in) | | | HP | Voltage | Amps | NEMA Plug | Cord Length (ft) | Crated Weight (lbs) |
|--------------|-------|---------|-------------------|----------|-------------------|-------|--------|-----|----------|------|-----------|------------------|---------------------|
| | | | Width | Height | Width | Depth | Height | | | | | | |
| MGD-3DR-80-X | 3 | 12 | 78" | 7.32283" | 78.375" | 30" | 83.5" | 3/4 | 115/60/1 | 10.7 | 5-15P | 10 ft. | 700 lbs. |

MOTAK reserves the right to make changes to the design or specifications without prior notice.

APR2321