



**WCA25**  
Café DECO™

**2.5-Liter Stainless Steel Airpot**



Café DECO™  
**2.5-liter Stainless Steel Airpot**



**MAIN FEATURES**

- For use with airpot brewers
- 2.5-liter capacity
- Stainless steel lined
- Keeps liquids hot for hours
- Vacuum-insulated design
- Removable lid for easy cleaning



The Waring Stainless Steel Airpot is best used in conjunction with Waring Commercial Airpot Brewers, to ensure you always have hot and fresh coffee!

WCM70PAP

Stainless steel airpot not included with coffeemakers.

**SALES FEATURES**

Fresh, delicious coffee is always hot and ready to serve with the Waring Commercial® Café Deco™ Stainless Steel Airpot. Specially designed for use with airpot brewers, it features a vacuum-insulated chamber that keeps coffee at just the right temperature for hours. The extra-large, 2.5-liter capacity makes it ideal for serving groups, and the removable lid ensures easy cleaning. Perfect for meeting rooms, breakfast bars, restaurants, and other operations where hot coffee is in high demand.



@waringcommercial

©2020 Waring Commercial  
314 Ella T. Grasso Avenue, Torrington, CT 06790  
Tel. 800-492-7464 • Fax 860-496-9008

[waringcommercialproducts.com](http://waringcommercialproducts.com)

**WCA25**



**DIMENSIONS**

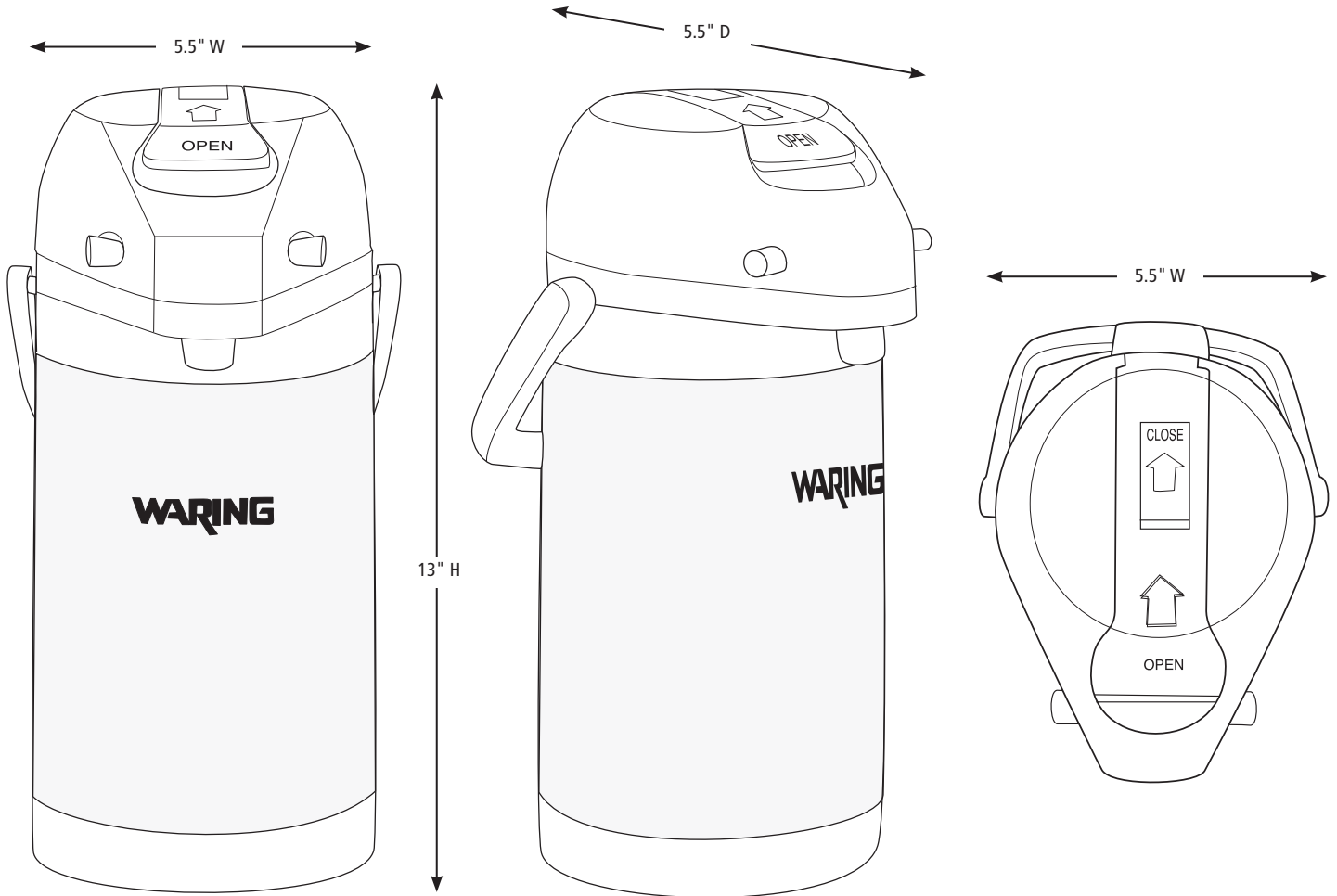

Out of Box Weight: 3 lb.

ORDERING INFORMATION	#STD. PKG.	GIFTBOX WEIGHT	CUBIC FEET	BOX DIMENSIONS D X W X H	UPC	CASE PKG.	MC WEIGHT	MC DIMENSIONS D X W X H	MBC
WCA25 – 2.5-Liter Stainless Steel Airpot	1	4	.42	7.125" x 7.125" x 14.625"	040072093692	6	24	15.625" x 15" x 22.125"	10040072093699



@waringcommercial

©2020 Waring Commercial  
314 Ella T. Grasso Avenue, Torrington, CT 06790  
Tel. 800-492-7464 • Fax 860-496-9008

waringcommercialproducts.com

20WC076274/ REV 11/20