

460 Southport Commerce Blvd.  
Spartanburg SC 29306  
Phone: 864-574-6004  
Fax: 864-574-6005

## INSTALLATION AND OPERATION MANUAL



CTFH-3

**Congratulations! You have just  
purchased the finest commercial  
refrigeration available.**

# TABLE OF CONTENTS

APPLICATION .....	3
PRODUCT REGISTRATION.....	3
DIRECTIONS FOR STORAGE AND HANDLING THE EQUIPMENT.....	3
STORAGE OF THE EQUIPMENT .....	3
UNCRATING.....	3
MOVING THE EQUIPMENT .....	3
PLACING AND INSTALLING THE EQUIPMENT.....	4
ELECTRICAL REQUIREMENTS .....	5
POSITIONING SHELVES.....	5
PRODUCT LOADING.....	5
UNIT OPERATION AND COMPONENTS.....	6
ELECTRONIC TEMPERATURE CONTROL:.....	6
SHELF SPECIFICATIONS.....	7
MAINTENANCE GUIDELINES.....	7&8

You have selected one of the finest commercial refrigeration units made. It is manufactured under strict quality controls with only the best quality materials available. Your Ojeda cooler, when installed correctly and properly maintained will give you many years of trouble-free operation.

## **WARNING!**

**USE THIS APPLIANCE FOR ITS INTENDED PURPOSE AS DESCRIBED IN THIS MANUAL**

When using electrical appliances, basic safety precautions should be followed, including the following:

- Use this appliance for its intended purpose as described in this Owner Manual.
- This freezer must be properly installed and located in accordance with the Installation Instructions.
- We strongly recommend that any servicing be performed by a qualified individual.
- Do not allow children to climb, stand, or hang on the shelves in the freezer. They could damage the freezer and seriously injure themselves.
- Do not store or use gasoline or other flammable vapors and liquids in the vicinity of this or any other appliance.
- Unplug the freezer before cleaning and making repairs.

## APPLICATION

CAREFULLY READ THESE INSTRUCTIONS. This manual provides instructions in how to best locate, operate, and maintain this equipment. It is recommended to keep this manual for any future reference.

The CTFH-3 has a sanitation listing permitting the merchandising of packaged food and beverage product. The unit must be located in an indoor environment where the ambient must be maintained less than 75° F/65° RH.

## PRODUCT REGISTRATION

Write down the Serial number of your new unit for future reference. The Serial Number is found on the data plate located on the back of the unit.

MODEL: \_\_\_\_\_

SERIAL NUMBER: \_\_\_\_\_

## DIRECTIONS FOR STORAGE AND HANDLING THE EQUIPMENT

### STORAGE OF THE EQUIPMENT

If the equipment will be kept in storage, it is suggested to keep it in its original packing. In case you need your equipment to be inactive for a long period of time after being used, verify that it has been unplugged. After cleaning it thoroughly with a damp cloth, lukewarm water and neutral soap and carefully drying it, cover it with a polyethylene film or similar waterproof material.

### UNCRATING

The following procedure is recommended for uncrating the unit:

Remove the outer package by carefully cutting the banding and removing the cardboard box. Inspect for concealed damage. Immediately file a claim with the freight carrier if there is damage. Move your unit as close to the final location as possible before removing the wooden skid.

### MOVING THE EQUIPMENT

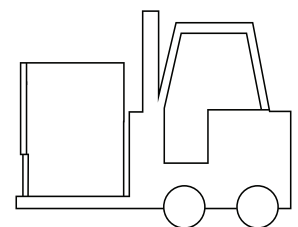

Figure 1

# PLACING AND INSTALLING EQUIPMENT

## ENVIRONMENTAL CONDITIONS

**THIS UNIT CANNOT BE INSTALLED IN ENVIRONMENTS WITH EXPLOSIVE GASES. THE EQUIPMENT IS DESIGNED ONLY FOR INDOOR OPERATION.**

The unit must be located in an indoor environment where the ambient is maintained less than 75oF/65%RH.

For the correct performance of the refrigerating system, it is very important to leave at least 10 cm (4") of free space both at the sides and back to allow proper air circulation.

The location of the cooler must be kept away from sources of heat and humidity including direct sunlight, toasters, ovens, coffee warmers, other appliances condenser air discharge, infrared heaters, or other heat generating appliances.

Overloading the freezer forces the compressor to run longer. Do not exceed the load limit according to labels fixed on the inner cabinet. Overloading the freezer forces the compressor to run longer. Do not exceed the load limit according to labels fixed on the inner cabinet. Keep the lids closed to avoid warm air and moisture getting into the freezer.

The unit should be leveled prior to operation.

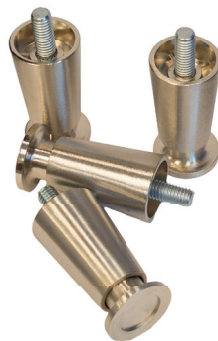
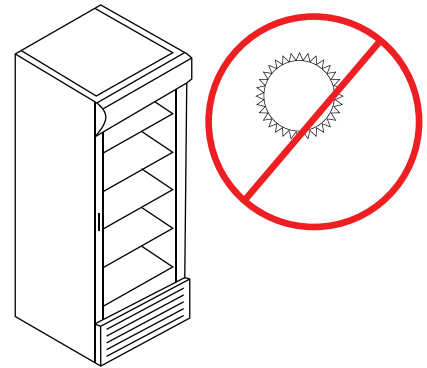

**Leveling Legs**

## ELECTRICAL REQUIREMENTS

The power cord of this appliance is equipped with a 3-prong (grounding) plug which mates with a standard 3-prong (grounding) wall outlet to minimize the possibility of electric shock hazard from this appliance.

The use of extension cords is not permitted and will void the warranty.

Model	Voltage (V)	Current (A)	Circuit Required (A)	NEMA Config.
CTFH-3	120	3.5	15	5-15R

Before connecting your equipment, check that the electrical data on the data plate match your electrical output. If voltage varies by 10 percent or more, freezer performance may be affected. Operating the freezer with insufficient power can damage the compressor. Such damage is not covered under the warranty. If you suspect voltage is high or low, consult your power company for testing. To prevent the freezer from being turned off accidentally, do not plug unit into an outlet controlled by a wall switch or pull cord. Do not pinch, knot, or bend the power cord in any manner.

**IMPORTANT NOTICE: PLUG THE EQUIPMENT INDEPENDENTLY TO A LOAD CENTER WITH AN APPROPRIATE CIRCUIT BREAKER ACCORDING TO THE NAMEPLATE AMPS.**

## POSITIONING SHELVES

The shelves and holders have been fixed to the inside floor of the unit to prevent their loss during transportation.

Insert the shelf brackets in the pilaster notches making sure they are at the same level such that the shelves remain horizontal.

IMPORTANT: The products on each shelf must leave three to five centimeters of free clearance between them and the next shelf in order to allow proper air circulation.

## PRODUCT LOADING

The CTFH-3 is not intended to be a pull down freezer and as such the product must be loaded at their intended merchandising temperature.

Before loading products, allow the equipment to operate empty for at least four hours.

## PREVENTION

- Do not block the lower ventilation grille with the packages about to be loaded.
- Do not over hang the shelf.
- Do not press the product against the rear wall
- Never exceed the shelf weight limits.

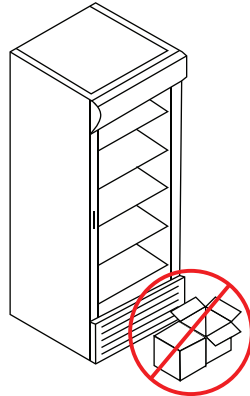

## UNIT OPERATIONS AND COMPONENTS

### CHANGING THE TEMPERATURE

To access the temperature control, the rear grill should be removed using a Phillips screw driver. The temperature control is factory pre-set to provide satisfactory product storage products. However, the temperature control is adjustable to provide a range of temperatures for your personal satisfaction. If a colder temperature is desired, turn the control clockwise. Allow several hours for temperature to stabilize between adjustments.

## CAUTION

The equipment has been exclusively designed to maintain the proper temperature of packaged fresh food and beverages. Because the unit is not designed to cool the product down quickly, the product must be loaded at its appropriate temperature.

- Do not remove grilles or panels that require using tools to be accessed
- Do not keep the unit running unloaded. UNPLUG IT when you are not planning to use it.

Using any electrical or electronic equipment entails the compliance with some fundamental rules.

- Do not touch the unit with wet hands or feet.
- Do not install the equipment outdoors.
- Do not remove or ignore safety devices.
- Do not leave objects on top of the unit.

## CAUTION CONT'D

- Do not climb on top of the unit.
- Never use direct or indirect water jets on the unit.
- Do not allow the electronic control to be adjusted by customers or unqualified personnel. For any adjustment you must contact your distributor.
- Verify that the hot air stream from the condenser towards the back of the unit is not directed to other refrigeration units, which would compromise their operation.
- Under no circumstance should you block the front grille of the unit.

**THE MANUFACTURER DOES NOT ASSUME ANY RESPONSIBILITY ARISING FROM DAMAGES CAUSED BY IMPROPER, INCORRECT, OR ERRONEOUS USE.**

It is important to instruct the user on the operation of the equipment according to this instruction manual, and to make sure that said manual is within reach of any operator that might use the unit.

## SHELF SPECIFICATIONS

The shelves have been designed to withstand the rigors of normal use and loading capacity not to exceed 40 pounds per square foot evenly distributed weight per shelf:  
This load limits must not be exceeded to prevent potential damage to the shelf and/or injury to users.

## MAINTENANCE GUIDELINES

Regularly and carefully cleaning the equipment prevents deterioration and product alteration.

### CLEANING THE UNIT EXTERIOR

Wash any removeable parts, the freezer interior, and exterior with a mild detergent and warm water. Wipe dry. **DO NOT USE HARSH CLEANERS ON THESE SURFACES!** Do not use razor blades or other sharp instruments, which can scratch the appliance surface.

Regularly and carefully cleaning and defrosting the equipment prevents deterioration and product alteration.

### REMOVAL OF FROST

It is recommended to remove the frost accumulated before reloading the freezer or anytime when one quarter inch of frost has accumulated. The unit will have to be manually defrosted. The manual defrost frequency will depend on the units usage, environment, and the amount of frost accumulated.

1. Make sure the unit is moved close to a floor drain or a means of collecting or containing the water is used.

2. Unplug the unit until all the frost is gone.
  3. When the ice has melted wipe up any water left on the freezer floor.
  4. Allow the freezer to refrigerate and cycle before placing the product back into the freezer
- To defrost while keeping the freezer plugged in place a clean dry soft cloth over the product to catch the frost that will be removed. Remove the frost using a plastic scrapper trying to eliminate as much frost as possible.

### CLEANING THE UNIT INTERIOR

**WARNING! DAMP OBJECTS STICK TO COLD METAL SURFACES.  
DO NOT TOUCH THE INTERIOR METAL SURFACES WITH WET OR DAMP HANDS.**

After defrosting, wash the inside surfaces of the freezer with a solution of two tablespoons of baking soda in one quarter of a gallon (1.1 liters) warm water. Rinse and dry. Wring excess water out of the sponge or cloth when cleaning in the area of the controls, or any electrical parts. Wash the removable parts and door with the baking soda solution, or mild detergent and warm water. Rinse and dry. Never use metallic scouring pads, brushes, abrasive cleaners, or alkaline solutions on any surface. Do not wash removable parts in a dishwasher. Do not shower water with a hose nor use ammonia based cleaners.

**WARNING! WARNING THE LOWER SIDE OF THE GLASS LIDS IS PROVIDED WITH A SPECIAL FILM. DO NOT USE RAZOR BLADES OR OTHER SHARP INSTRUMENTS WHICH CAN SCRATCH THIS SURFACE AND DAMAGE THE FILM.**



If technical personnel assistance is required, you must immediately contact your distributor, specifying the kind of problem and clearly indicating the equipment model and serial number. If replacing parts is required, do it through your distributor.

**WARNING:** Always ask for original spare parts

**AUTHORIZED DISTRIBUTOR:**

---

**COMMERCIAL NAME:**

---

**ADDRESS:**

---

**TELEPHONE:**

---

**E-MAIL:**

---