



# SM50

ICE MACHINE



**Manitowoc®**



The SM50 ice machine combines

# *design and performance*

The compact design accommodates the most intimate settings while the performance meets professional standards.

## Features and Benefits

Individual cubes with unique octagon shape.

Easily accessible control panel with the following functionality:

- Automatic ice making mode
- Patented cleaning and sanitizing
- Delay start option
- Filter replacement warning light

Manitowoc's SM50 is the first ice machine with a water filter system preinstalled.

The SM50 provides convenient accessibility to ice with a LED lighted bin and an easy to locate ice scoop.

3-year parts and labor warranty on entire machine.

## Cube Size

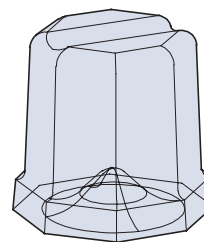

**Standard**  
1 $\frac{3}{8}$ " x 1 $\frac{3}{8}$ "  
(33 x 34 mm)

## **SM50**

Production Capacity	53 lbs. (24 kgs.) in 24 hours*
Storage Capacity	25 lbs. (11 kgs.)
Bin Melt Rate	The SM50 leads the industry** in ability to store ice in hot ambient conditions. The ice bin is fully insulated to mitigate melting, this is especially important when installing the equipment in a hot environment.
Water Filtration	6 month minimum expected life
Drain Pump	Optional drain pump easily integrates inside the machine during installation. Perfect for locations without access to a gravity drain.

\* Production capacity at 70° ambient temperature and 50° incoming water.

\*\* Industry leading melt rate based on testing of similar equipment in the Maniowoc test lab.





## Control Panel Features

*Automatic Ice Making Mode* – ensures bin is always full.

*Delay Start Mode* – with temporary shut off and auto restart control.

*Clean Mode* – once cleaning cycle is completed, machine automatically resets back into ice production mode.

*Indicator Light* – flashes when water filter requires replacement.

## Ice Accessibility

*Bin Opening* - Oversized for easy access to ice.

*Scoop Mount* - easy removal and convenient storage.

*Lighted Bin* - illuminates stored ice for easy retrieval in low light conditions and highlights bin area for thorough cleaning.

## Door Opening

Ships with hinge on the right, easily changed to left during installation.



## Water Filtration System

*Depth Filtration with Scale Inhibitor* - ensures maximum water filtration.

*Valve-in Head* - simply insert and twist to lock or unlock filter - no tools required.

*Auto-Bypass* - water bypass is enabled when filter is removed.

*Water Filter* - durable water filter is designed to last six months under normal operating conditions. Filter replacement light indicates when changeover is needed.

## Adjustable Height

Front and back levelers standard 0" to 1" (0-2.5 cm).

*Optional stainless steel legs* available 4.25" to 6.00" (10.80-15.24 cm)





+1 800.545.5720 | MANITOWOCICE.COM

Manitowoc Ice offers commercial grade

# *compact ice machines*

for business applications



## Easy to Install

Designed to be installed into standard cabinet dimensions 15.00" (38.00 cm) or stand alone with stainless top and sides standard.

Front and back levelers allow for height adjustments.

Ships with hinge on the right, easily changed to left during installation.

Air flows in and out the front of the ice machine to accommodate both built-in and stand-alone installations.

***Manitowoc Ice is the trusted leader when it comes to dependability and innovative solutions for commercial kitchens. Now Manitowoc offers that same dependability for corporate and business applications.***

## Warranty

3-year parts and labor  
Warranty on entire machine.

Note: This product is intended exclusively for commercial application. No warranty is extended for personal, family, or household purposes.

Our customized solutions provide much more than just temporary enhancements. Backed by decades of experience in the industry, our products are relentlessly reliable, built to last and withstand the daily pressures of food service demands. And that's the same dependability reflected in our own strong support network, providing the consistent service you need at every stage of your business.



2110 South 26th Street  
Manitowoc, WI 54220

Tel: 1.920.682.0161  
Fax: 1.920.683.7589

www.manitowocice.com  
7927B 06/2022