

Project _____

Item Number _____

Quantity _____

SFG600TM/TMM/TL



Reversible Dough Sheeter

Models:

- SFG 600 TM: Floor Model
- SFG 600 TMM: Floor Model
- SFG 600 TL: Floor Model



Dough Sheeter

Features:

- Reversible dough sheeter
- Hand operation for thickness and foot pedal operation for carpet (left to right)
- 0 to 1.9" (4.8cm) adjustable cylinder, separation changes dough thickness
- Hard chrome polished cylinders
- Tables fold upright for storage and movement
- Powerful 3/4 or 1 hp motor
- Sheets dough onto rolling pins to allow for transport of rolled dough to work area
- Interlock switches protect operator from injury if safety guard is opened
- Pivoting and removable arms
- Convenient storage in base for rolling pins

Standard Accessories:

- Heavy duty rolling pins
- Designated area for flour storage for use while sheeting

Optional Accessories:

- Hand operation for carpet (left to right) need to specify when ordering
- Contact Factory for cutting roller attachments (ONLY ON THE SFG600TL MODEL)

Warranty:

- One year, on-site parts and labor

Univex Corporation



WE RAISE THE BAR. WE SET THE STANDARD.

Reversible Dough Sheeter

SFG600TM/TMM/TL

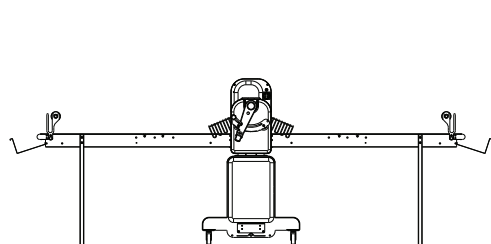

Side View

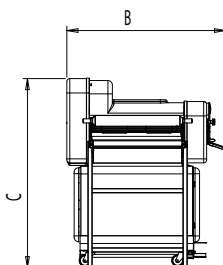

Floor View

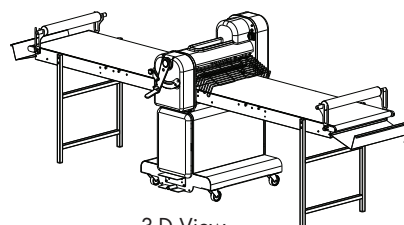

3-D View

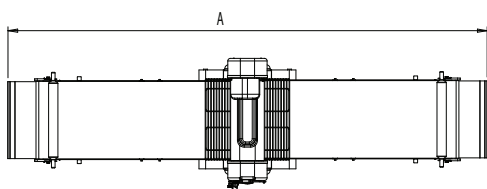

Plan View

Line drawing is the SFG600TMM

	SFG600TM	SFG600TMM	SFG600TL
A	111.2" (282.5cm)	145.91" (370.6cm)	127.95" (325cm)
B	42.2" (107.2cm)	42.2" (107.2cm)	42.16" (107.1cm)
C	50" (127cm)	50.28" (127.7cm)	50.28" (127.7cm)

Other Dimensions

Model	Base Length	Belt Width	Length Folded	Height Folded	Carpet Length
SFG600TM	29.625" (75.3cm)	23.75" (60.3cm)	43.375" (110.2cm)	58.375" (148.3cm)	46.5" (118.1cm)
SFG600TMM	29.625" (75.3cm)	23.75" (60.3cm)	Due to length of tables and for safety reasons, sheeters cannot be stored in folded position.		63" (160cm)
SFG600TL	29.625" (75.3cm)	23.75" (60.3cm)		63" (160cm)	

Controls: Main power switch, emergency stop switch and direction control lever and foot pedal for forward and reverse table directions. Manually adjustable space between rolling cylinders adjusts in increments from 0" to 1.9" (0 to 4.8cm)

Drive: Chain drive

NEMA #: L-15-20

Optional Voltages:

SFG600TM & SFG600TMM & SFG600TL:

- 115/60/1
- 220/60/1
- 400/60/1
- 400/60/3

Electrical Information (60Hz)

Model	Standard Voltage	Phase	hp(kW)	Amps
SFG600TM	220	3	0.75 (0.55)	2.60-7.35
SFG600TMM	220	3	1.00 (0.75)	4.48-9.11
SFG600TL	220	3	1.00 (0.75)	4.48-9.11

Shipping Information

Model	Net Weight	Shipping Weight	Overall Dimensions
SFG600TM	512 lbs. (232Kg)	622 lbs. (282Kg)	61.4" (156cm) H x 36.6" (93cm) W x 55.9" (142cm) D
SFG600TMM	573 lbs. (260Kg)	683 lbs. (310Kg)	72.8" (185cm) H x 35.4" (90cm) W x 56" (142cm) D
SFG600TL	661 lbs. (300Kg)	772 lbs. (350Kg)	72.8" (185cm) H x 35.4" (90cm) W x 56" (142cm) D



Univex Corporation
www.Univexcorp.com

3 Old Rockingham Rd
Salem, NH 03079
United States of America

TEL: (800)258-6358
INTL TEL: (603)893-6191
FAX: (800)356-5614
INTL FAX: (603)893-1249