

Replacement Parts Chart

Stainless Steel Pumps

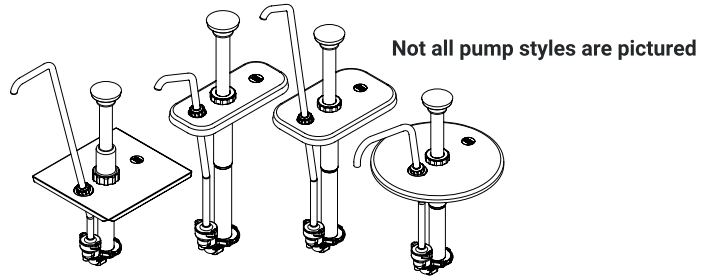
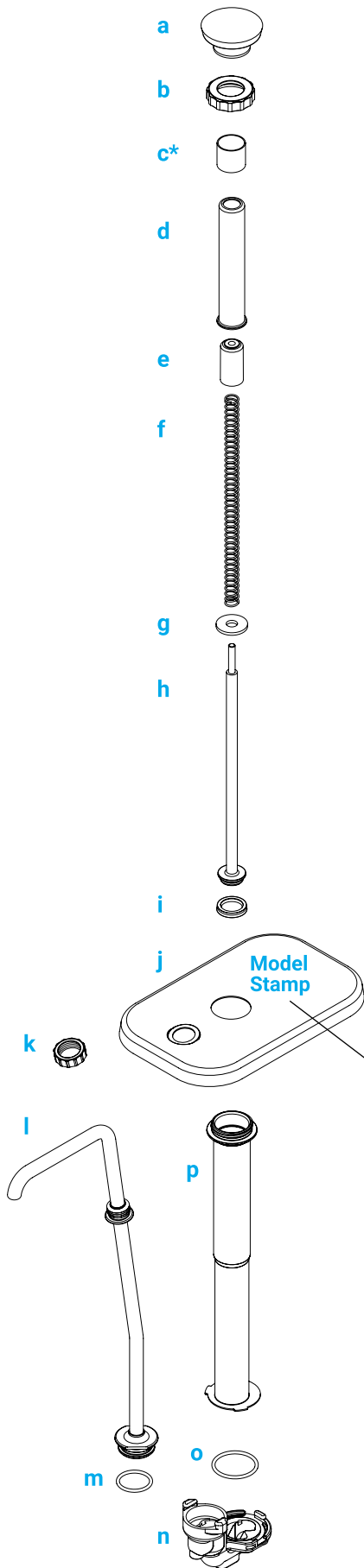

Stainless Steel Pumps

	Cleaning Brush, 1 1/4" Dia.	82049
	Cleaning Brush, 21" Long	82526
	Cleaning Brush, 21" Long (used with 1/2" tube)	84257
	Food Equipment Lubricant, 1/4 oz	40179
a	Knob, Black	82023-000
b	Locking Collar	See Chart
c*	Optional: Gauging Collars	
	For 1-oz & 1 1/4-oz Pumps:	
	1/4 oz Portion Reduction Collar	82022
	1/8 oz Portion Reduction Collar	83529
	For 2-oz Pumps:	
	1/2 oz Portion Reduction Collar	88568
	1/4 oz Portion Reduction Collar	88571
d	Head Tube	See Chart
e	Head Insert	82018
f	Spring, 7"	82016
	Spring, 10"	82077
g	Washer (for 1- & 1 1/4-oz pumps)	82015
	Washer (for 2-oz pumps)	87602
h	Piston	See Chart
i	Seal Assembly (for 1- & 1 1/4-oz pumps)	83003
	Seal Assembly (for 2-oz pumps)	88565
j	Lid (See Parts Breakdown at server-products.com)	
k	Discharge Tube Nut	82027
l	Discharge Tube	See Chart
m	Discharge Tube O-Ring, 1"	05127
n	Valve Body, Captured Balls	See Chart
o	Cylinder O-Ring/Gasket	See Chart
p	Cylinder O-Ring/Gasket	See Chart
	St. St. Ball, 1/2" (in pumps prior to 1999)	06022

NOTE: Used to determine parts in chart on [p 84-85](#)

Wear parts like seals, springs and o-rings can be replaced, so you shouldn't need to buy a new complete pump again.



Parts & Price Guide

Stainless Steel Pumps – Replacement Parts Chart

pump/model	pk parts kit	b locking collar	d head tube	f spring	h piston and seal assy	l discharge tube	n valve body kit	o o-ring/gasket	p cylinder
06110 BSW	82898	82021	82017	82016	100075	82493	82431	82323	82336
67540 CPSS-F	82898	82021	82017	82016	100075	82375	82433	82323	82336
67570 CPSS-FL					82013				
81320	82898	82021	82017	82016	100075	82485	82431	82323	82336
82000 SP						82489			
82070 FP	82898	82021	82078	82077	83398	82476	82431	82323	82348
82100 FP-200	82898	82106	82017	82016	100075	82497	82431	82323	82358
80030 FP-200 DI	82898	82106	82017	82016	100075	80032	82431	82323	82358
82120 FP-V	82898	82021	82078	82077	83398	82487	82431	82323	82348
82130 FP-200V	82898	82106	82017	82016	100075	82499	82431	82323	82358
82430 CP-F (Pouch)	83062	82728	82017	82077	83398	82664	82635	88554	82665
82520 FPV-DI	82898	82021	82078	82077	82076	82515	82431	82323	82348
82720 CP-200 (Pouch)	83062	83412	82017	82016	100075	82637	82635	88554	82362
82740 FPEC	83062	83412	82017	82016	100075	82643	82635	88554	82362
82800 FPEC						82806			
82990 FP-DI	82898	82021	82078	82077	83398	82495	82431	82323	82348
83000 CP-10	82898	82021	82017	82016	100075	82371	82431	82323	82336
83020 CP-3							82431		
83110 CP-G (120 mm)	82898	82021	82017	82016	100075	82373	82433	82323	82336
83120 CP-G (110 mm)									
83130 CP-G (89 mm)									
83200 CP-6 ½									
83220 CP-8 ½	82898	82021	82017	82016	100075	82374	82431	82323	82336
83910 CP-8 ½ L									
83240 CP-10 ½									
83300 CP-200	82898	82106	82017	82016	100075	82372	82431	82323	82358
83330 CP-F	82898	82021	82078	82077	83398	82369		82323	82348
83400 CP-¼									
83420 CP-¼	82898	83412	82017	82016	100075	82376	82431	82323	82362
83430 CP-⅓									
83433 CP-⅓ (Tall)									
83437 CP-¼ (Tall)	82898	83412	82017	82016	100075	83431	82431	82323	82362
83441 CP-⅓ (Tall)									
83447 CP- ½ DL (Tall)									
83480 CP-½ DL									
83920 CP-5	82898	83412 82021	82017	82016	100075	82376 82374	82431	82323	82362 82336
85050 FPSA	83062	82106	82017	82016	100075	85065	85038	88554	82358
85300 FP-V Slim	82898	82021	82078	82077	83398	82487	82431	82323	82348
85310 FP-200V Slim	82898	82106	82017	82016	100075	82499	82431	82323	82358
85320 SP-3	82898	82021	82017	82016	100075	85324	82431	82323	82336
85330 CP-200 Slim	82898	82106	82017	82016	100075	82372	82431	82323	82358
85340 CP-F Slim	82898	82021	82078	82077	83398	82369	82431	82323	82348
85350 FP-200 Slim	82898	82106	82017	82016	100075	82497	82431	82323	82358
85360 FP Slim						82476			
85370 FP-DI Slim	82898	82021	82078	82077	83398	82495	82431	82323	82348
85380 FPV-DI Slim						82515			
85820 FP-EZT	83062	83412	82017	82016	100075	85827	82635	88554	82362
86312 FP-⅙	82898	83412	82017	82016	100075	86314	82431	82323	82362

Stainless Steel Pumps – Replacement Parts Chart (cont'd)

pump/model	pk parts kit	b locking collar	d head tube	f spring	h piston and seal Assy	i discharge tube	n valve body kit	o o-ring/gasket	p cylinder
86750 TP-200V		82106	82017	82016	100075	82459			82358
86760 TP-V	82898	82021	82078	82077	83398	82455	82431	82323	82348
86770 TP-200V (Slim)		82106	82017	82016	100075	85459			82358
86780 TP-V (Slim)		82021	82078	82077	83398	82455			82348
87249 CP-1/8 Tall						83431			
87300 CP-1/8	82898	83412	82017	82016	100075	82376	82431	82323	82362
87310 FP-1/8						83074			
87600 FP (2 oz)				82725	88599	82476	82431		88598
87610 CP-200 2 oz	88628	87601	88556	82077	88558	82372	82431	88554	88561
87620 CP-8 1/2 2 oz						88569	85891		
87630 CP-1/8 2 oz									
87640 CP-1/8 2 oz	88628	87603	88556	82077	88589	82376	82431	88554	88558
87650 FP-V 2 oz						82487			
87660 CP-F 2 oz	88628	87601	88556	82077	88599	82369	82431	88554	88598
87670 FP-200V 2 oz	88628	87601	88556	82077	88558	82499	82431	88554	88561
87680 CP-10 1/2 (2 oz)									
87700 CP-6 1/2 (2 oz)	88628	87601	88556	82077	88558	88569	85891	88554	88561
94010 CSM	94043	82021	82017	82016	100075	82427	82431	82323	82336
94040 CSP 1 oz	82898	83412	82017	82077	100075	94084	82431	82323	94093
94080 MMS	82898	82021	82017	82016	82013	82424	82431	82323	82336

For more detail, Parts Breakdowns are available at server-products.com



Simplify Ordering with a Parts Kit! (column pk above)

82898 Parts Kit Includes:

Cleaning Brush, 1 1/4" Dia.	(1) 82049
Cleaning Brush, 21" Long	(1) 82526
Food Equipment Lubricant, 1/4 oz	(1) 40179
e Head Insert	(1) 82018
f Spring, 7"	(1) 82016
Spring, 10"	(1) 82077
g Washer (1 & 1 1/4 oz)	(2) 82015
i Seal Assembly (1 & 1 1/4 oz)	(3) 83003
m Discharge Tube O-Ring, 1"	(3) 05127
o Cylinder O-Ring (1 & 1 1/4 oz)	(5) 82323
k Discharge Tube Nut	(1) 82027

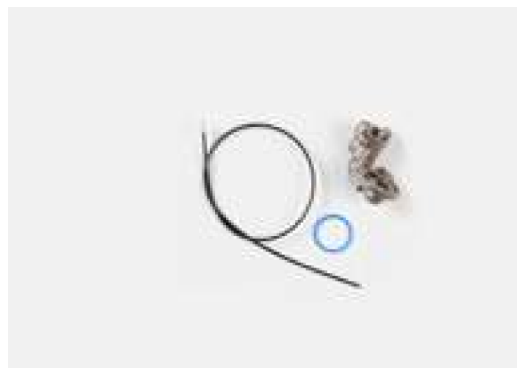

Valve Body Kits Include (column n above)

Valve Body, Captured Balls	Varies
O-Ring, 1 5/16"	82323
Brush, 21"	82526