

Replacement Parts Chart

Eco Pumps

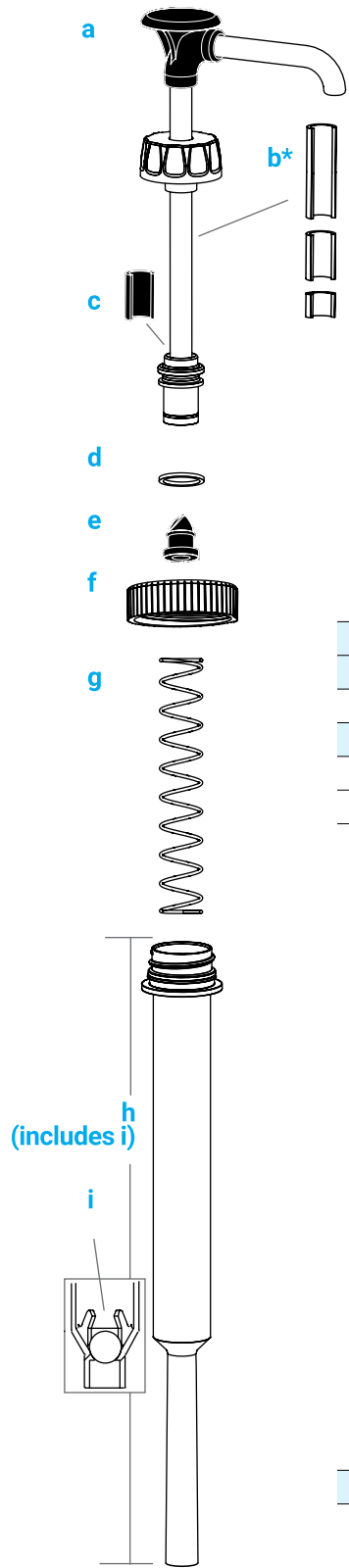

Server Eco Pumps™ are NSF listed. Plus, clean-in-place certification means proper cleaning can be done without disassembly.

Server Eco Pumps™ (Except BP-1 Thick 88220)

Cleaning Brush, 1 ¼" Dia.	82049
Cleaning Brush, 21" Long	82526
Food Equipment Lubricant, ¼ oz	40179
b* Optional: Gauging Collars	
½ oz Portion Reduction Collar	88205
¼ oz Portion Reduction Collar	88204
⅛ oz Portion Reduction Collar	88313
c Stop Collar (required for operation)	88409

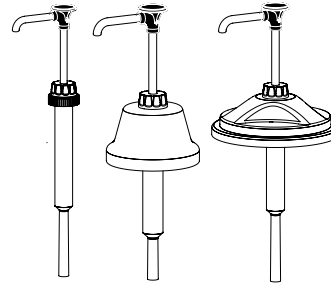

Not all pump styles are pictured.

pump/model	a head assembly	d seal	e pinch valve	f cap/lid	g spring	h cylinder assembly	i stainless steel ball
88000 BP-1, 38 mm				88016		88496	
88010 BP-1, 110 mm	88303	83005	88202	88041	88166	88311	06022
88020 BP-1, Crock	88304	83005	88202	88056	88166	88312	06022
88150 BP-¼, ¼-Jar	88175	88162	88188	87248	88189	88087	88258
88180 BP-¼, 28 mm	88175			88213 & 88276	88189	88085	
88190 BP-½, 28 mm	88232	88162	88188		88233	88089	88258

Server Eco Pump BP-1 Thick

Cleaning Brush, 1 ¼" Dia.	82049
Cleaning Brush, 21" Long x ½"	84257
Food Equipment Lubricant, ¼ oz	40179
b* Optional: Gauging Collars for BP-1 Thick Pump (only)	
½ oz Portion Reduction Collar	88879
¼ oz Portion Reduction Collar	88888
⅛ oz Portion Reduction Collar	88887
c Stop Collar (fixed, incorporated into head)	none



pump/model	a head assembly	d seal	e pinch valve	f cap/lid	g spring	h cylinder assembly	i stainless steel ball	j extension tube, 2 ½"
88220 BP-1, Thick	89215	100345	88203	88016	88166	88496	06022	88315