



Model: \_\_\_\_\_ Item #: \_\_\_\_\_ Date: \_\_\_\_\_

Project: \_\_\_\_\_ Qty: \_\_\_\_\_ Approved By: \_\_\_\_\_

## Combination Ice Bins with 12" Bottle Storage

Royal Series Underbar



KR19-M36L-10  
shown with optional  
Wire Racks (KR-421)



### Standard Features

- 12" deep ice bin with 1" drain, 1/2" drain with cold plate
- Insulated 12" bin section for wire racks or bottle wells with 1" drain
- Soda line access cutout in rear on cold plate units
- Optional 15" deep liner that holds 25% more ice (KR-502)
- Optional built-in speed rail
- 10-Circuit cold plate available
- Ice bins with cold plates include 1/2" x 6" PVC tailpiece (1/2"- 20 male threaded)
- Ships as a complete station

### Specifications

- Interior: 20 gauge stainless steel.
- 12" deep ice bin section, 10" deep bottle section
- Front apron: 20 gauge stainless steel clad over 20 gauge galvanized steel
- Sides: 20 gauge stainless steel
- Backsplash: 20 gauge stainless steel
- Back & Bottom: 20 gauge galvanized steel

### Materials

- 1" NPS drain, bottle section
- 1" IPS drain, ice bin
- 1/2" IPS drain, ice bin with cold plate
- Ice bin with cold plate includes 1/2" x 6" PVC tailpiece (1/2" - 20 threaded). PVC tailpiece required to avoid condensation through metal to metal contact.

### Drains & Plumbing

- Cast aluminum post mix plate with 10 circuits. Plate is sealed into bottom. Each circuit is 5/16" OD stainless steel tubing. Two full with remainder to be half circuits. Bump and swedge fittings on ends.

### Cold Plate

### Tubing Access (Cold Plate)

- 3/4" x 3-1/2" cutout in left side of backsplash

### Insulation

- Foamed-in-place polyurethane

### Backsplash

- 6-1/2"H x 1-1/2"D

### Legs

- 1-5/8" tubular legs w/ grey plastic bullet foot

### Optional Speed Rails



RS-24

RD-24

### Single Speed Rails

Model	Length
RS-36	36"
RS-42	42"
RS-48	48"

### Double Speed Rails

Model	Length
RD-36	36"
RD-42	42"
RD-48	48"



Cold Plate Units supplied with 1/2" x 6" PVC tailpiece (1/2" - 20 male threaded)  
Model: KR-CPN6

### Options & Accessories

Model	Description
KR-103	12" Deep Stainless Steel Divider for 19"D Ice Bins (KR19)
KR-109	12" Deep Stainless Steel Divider for 19"D Ice Bins (KR19)
KR-113	15" Deep Stainless Steel Divider for 24"D Ice Bins (KR24)
KR-114	15" Deep Stainless Steel Divider for 24"D Ice Bins (KR24)
KR-303	Left & Right End Side Splashes for 19"D Ice Bins (KR19)
KR-310	Right End Side Splash for 19"D Ice Bins (KR19)
KR-311	Left End Side Splash for 19"D Ice Bins (KR19)
KR-313	Left & Right End Side Splashes for 24"D Ice Bins (KR24)
KR-314	Right End Side Splash for 24"D Ice Bins (KR24)
KR-315	Left End Side Splash for 24"D Ice Bins (KR24)

Model	Description
KR-401	Cap Catcher and Opener
KR-406	Faucet Installed Over Ice Bin
KR-421	2 Metal Wire Racks
KR-501	Towel Ring
KR-502	15" Deep Liner on Ice Station
SC"XX"H	Partial Sliding Cover Ice Bin ("XX" denotes size of Ice Bin. Example: SC24H)
SC"XX"F	Full Sliding Cover Ice Bin ("XX" denotes size of Ice Bin. Example: SC24F)



Model: \_\_\_\_\_ Item #: \_\_\_\_\_ Date: \_\_\_\_\_

Project: \_\_\_\_\_ Qty: \_\_\_\_\_ Approved By: \_\_\_\_\_

## Combination Ice Bins with 12" Bottle Storage

Royal Series Underbar

Top View

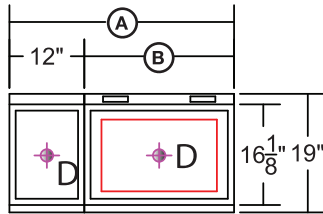

Front View

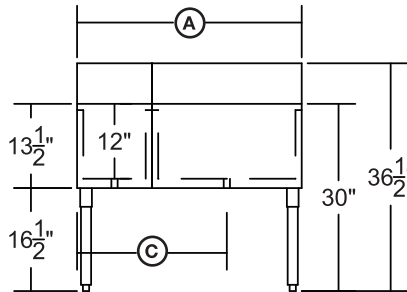

Front View - Cold plate models

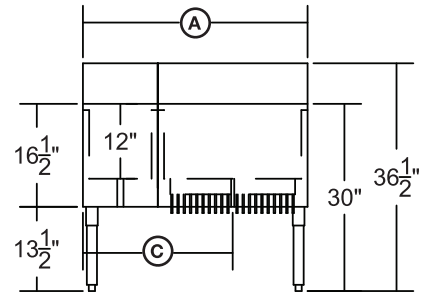

### 19" Depth

19" Depth								Cold Plate Models		
Overall Length A	Depth	Ice Bin Length B	Ice Bin Location	Left Side to Ice Bin Drain C	Ice Capacity	Bottles Stored	Model	Wgt. (lbs.)	Models with Cold Plate	Wgt. (lbs.)
36"	19"	24"	Right	24"	74	6	KR19-M36R	95	KR19-M36R-10	172
36"	19"	24"	Left	12"	74	6	KR19-M36L	95	KR19-M36L-10	172
42"	19"	30"	Right	27"	92	6	KR19-M42R	108	KR19-M42R-10	185
42"	19"	30"	Left	15"	92	6	KR19-M42L	108	KR19-M42L-10	185
48"	19"	36"	Right	30"	110	6	KR19-M48R	116	KR19-M48R-10	193
48"	19"	36"	Left	18"	110	6	KR19-M48L	116	KR19-M48L-10	193
48"	19"	24"	Center	24"	74	12	KR19-M48C	116	KR19-M48C-10	193

Top View

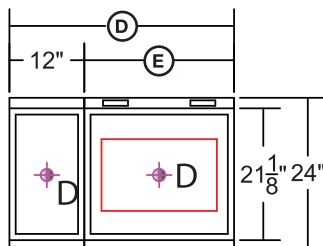

Front View

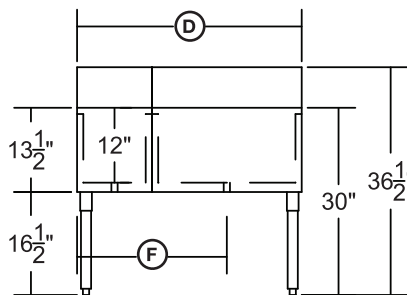

Front View - Cold plate models

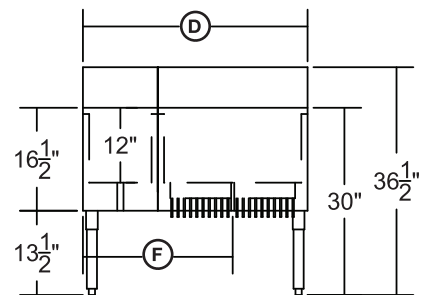

### 24" Depth

24" Depth								Cold Plate Models		
Overall Length D	Depth	Ice Bin Length E	Ice Bin Location	Left Side to Ice Bin Drain F	Ice Capacity	Bottles Stored	Model	Wgt. (lbs.)	Models with Cold Plate	Wgt. (lbs.)
36"	24"	24"	Right	24"	92	8	KR24-M36R	108	KR24-M36R-10	185
36"	24"	24"	Left	12"	92	8	KR24-M36L	108	KR24-M36L-10	185
42"	24"	30"	Right	27"	115	8	KR24-M42R	121	KR24-M42R-10	198
42"	24"	30"	Left	15"	115	8	KR24-M42L	121	KR24-M42L-10	198
48"	24"	36"	Right	30"	138	8	KR24-M48R	129	KR24-M48R-10	206
48"	24"	36"	Left	18"	138	8	KR24-M48L	129	KR24-M48L-10	206
48"	24"	24"	Center	24"	92	16	KR24-M48C	129	KR24-M48C-10	206