

# 5070

## High-temp Undercounter Glass Washer

Model #: **MD-GW-HTB22P**

### Product Details

- Heavy duty stainless steel construction front, top and sides
- Built-in detergent and rinse-aid dispenser
- Built-in rinse pump and pressure guage
- AISI-304 Stainless steel
- Higher clearance: 17"
- Advance soft-lift counterbalanced system and magnetic switch for the hood
- IPX4 - Stronger protection against water hose cleaning and external humidity
- Digital Controls: Simple digital control panel with temperature display for intuitive and user-friendly operation, IPX-4 proof.
- Effi Wash: Optimized hydraulic system provides a strong mechanical action combined with the optimum clean water in the tank. Balanced power keeps the perfect sanitation temperature during the cycle of the wash
- Soft Start: Wash-pump power control that prevents wares from damage at the beginning of the washing cycle while assuring a low noise level in your facility.

Not suitable for installation in non-commercial or residential applications.

### Certifications



### Size

18-1/2"W x 20-5/8"D x 28-1/8"H

### Cycle Periods

90/120/180 seconds

### Capacity

30 Racks per hour



# 5070

## High-temp Door Type Dishwasher

Model #: MD-GW-HTB22P

### Plan View

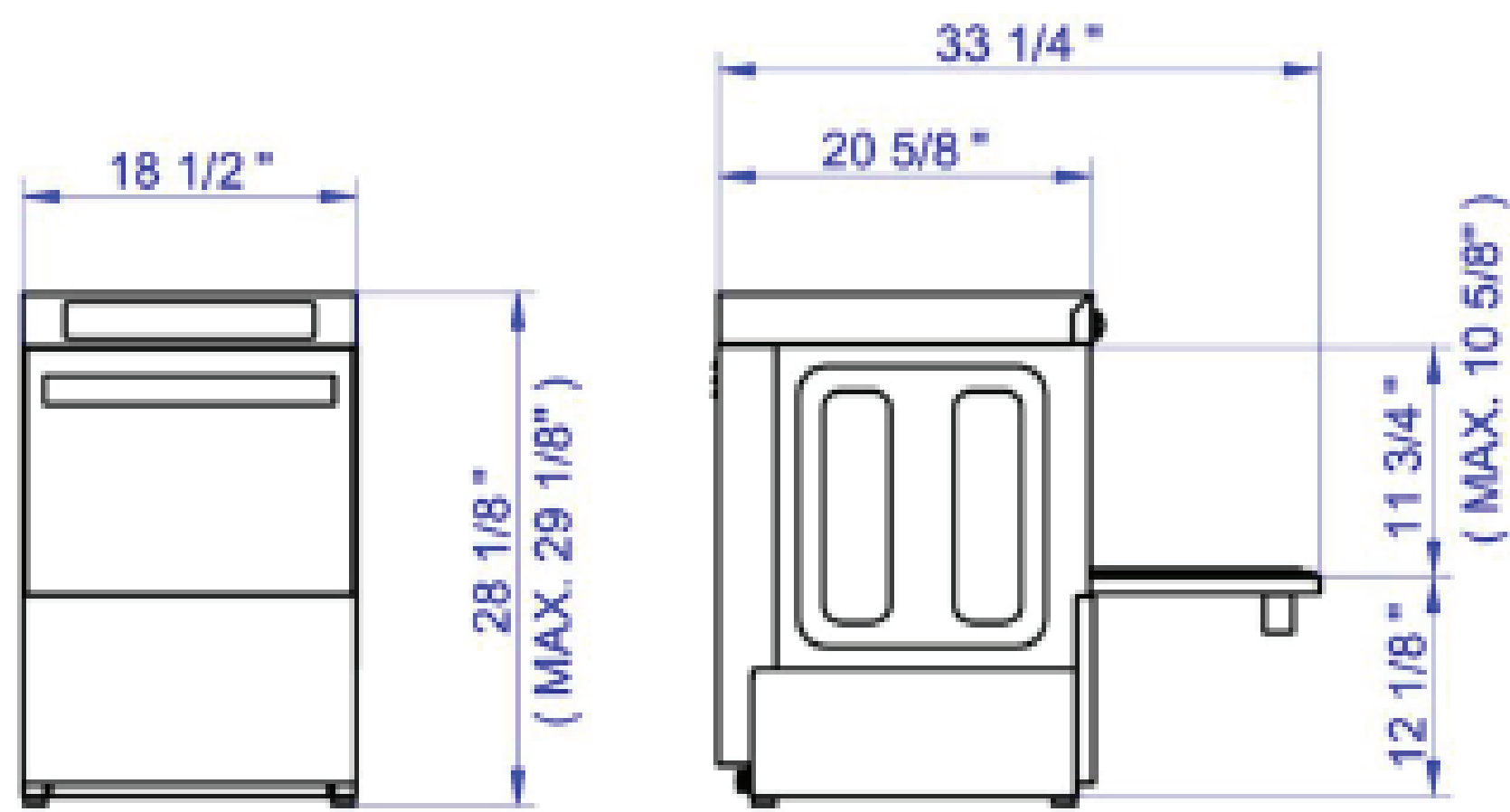

A	Water inlet	3/4"
B	Drain hose	5'
C	Power supply cable, strain relief	
E	Rinse aid inlet	
F	Detergent inlet	
G	Equipotential bond	

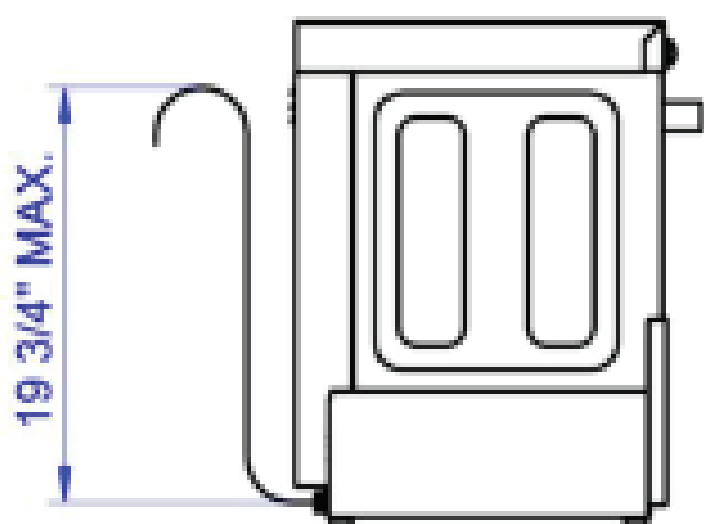
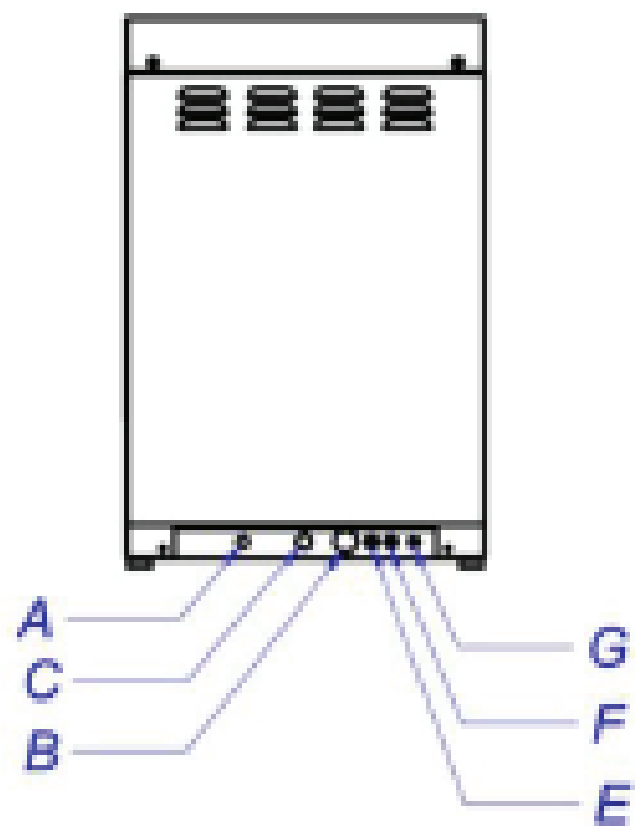

### Specifications

	MDGWHTB22P
Voltage	208-230V/1Ph/60Hz
Wash Pump(s)	0.28 kW
Tank Heating Element	2.18 kW
Boiler/Booster Heating Element	3.05 kW
Total Power	3.2 kW
Wash Pump Motor	1/3 HP
Clearance	10-5/8"
Work Height	12-1/8"
Tank Capacity	4 gal.
Boiler Capacity	1.05 gal.
Water Pressure	20-25 psi
Water Consumption Per Cycle	0.53 gal.
Water Consumption Per Hour	15.9 gal.
Water Protection Rating	IPX4
Washing Water Temperature	150°F
Rinsing Water Temperature	180°F
Water Inlet	3/4"
Water Inlet Temperature	120°F-140°F
Net Weight	97 lbs.
Gross Weight	103 lbs.
Packing Size	21"W x 26"D x 35"H
Noise Level	<70 dBA