

# Bar Equipment

**BACK & SIDE MOUNTED CONDENSING UNIT (EBB, EBD, EGC & ECF SERIES)**

Refrigerators / Chillers



The Bar Equipment series comes in a variety of styles and functions that meet all the needs of the food and drinks industry. From customizable draft faucets to canned/bottled drink storage and display, or a hybrid of both – the line is robust as it is reliable.

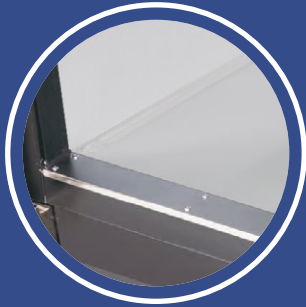

**Reinforced Door Threshold**

Protects interior floor when loading heavy contents.



**Detachable Drip Tray\***

Stainless steel tray is removable for easy cleaning.



**Cold Air Hose\***

Cools the draft tower for colder beer or coffee.



**3/4" External Drain Port\***

Compatible with standard hoses. Hose not included.



**Blizzard R290**

EPA/DOE approved, all-in-one, slide-out cooling cartridge.



**Digital Control**

Easy settings with audio and visual overheat alarm.



**ECM Fan Motors**

Electronically commutated motors require less energy.



**Other Features**

LED lighting, 2.5" thick insulation, 3" or 5" swivel casters.



**More Features**

Lockable door or lid, ridge-lined gasket.



EBB23G



EBB48G



EBB48G-SS



EBB59G



EBB59G-SS



EBB69G



EBB90G

## Cabinet Construction

- Heavy duty stainless steel countertop with textured laminate, black vinyl exterior. Stainless steel exterior for models EBB48G-SS and EBB59G-SS.
- Galvanized steel interior walls and high quality stainless steel floor.
- 1 3/4" thick high density polyurethane insulation.
- Four pre-installed 5" swivel casters with locks on front set (applies only to model EBB23G).
- Built-in caster thread receptacles for all models.

## Refrigeration System

- Side mounted, self-contained and fully detachable Blizzard R290 condensing unit uses environmentally friendly, EPA-compliant R290 refrigerant with zero (0) Ozone Depletion Potential (ODP) and three (3) Global Warming Potential (GWP). Blizzard R290 is easily replaceable and requires no on-site brazing (Blizzard R290 condensing unit is back mounted for model EBB23G).
- Electronically commutated (ECM) fan motors achieve rapid cooling with less energy consumption.
- Full-length air duct ensures optimal cold air circulation.
- Time-initiated and temperature-terminated auto defrost cycle for seamless operation.
- Large capacity, corrosion-resistant condenser and evaporator coils.
- Self-maintaining, energy-efficient condensate drain pan requires no external drains or electric heaters.
- High performance, auto-reverse condenser fan motor supports compressor ventilation and condenser coil cleaning.
- Pre-wired and ready to plug, 115V/60Hz/1Ph, NEMA 5-15P.

## Lighting

- Shielded LED bar lighting with on/off switch provides bright, high color illumination at lower heat output.

## Doors

- Low emissivity double glass panes reflect UV rays for efficient cooling.
- Black PVC frames. Matte finish aluminum door frames for models EBB48G-SS and EBB59G-SS.
- Snap-in magnetic gasket for ease of cleaning.
- High strength, die-cast handles.
- Pre-installed locks keep your items safe from theft.

## Shelving

- Two epoxy coated, steel wire shelves per section.
- Height adjustable stainless steel clips.

## Temperature Control

- Multi-function digital controller with easy to read LED display.
- Factory preset temperature, 35°F. Temp-set range from 33°F to 54°F.
- Audible overheat protection alarm for compressor and condenser coil.

## Options

- Additional shelving.
- 3" or 5" swivel casters with locks.
- 3.5" – 6" height-adjustable and interchangeable legs.

↔ = Interior Dimensions   ←→ = Exterior Dimensions

Side View (all models except EBB23G)

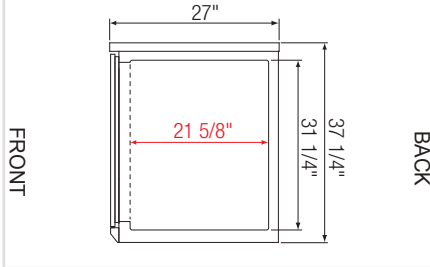

Side View & Air Flow (EBB23G)

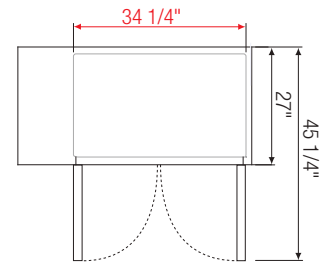
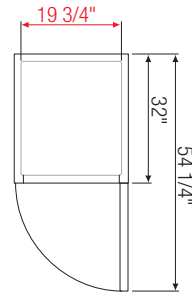
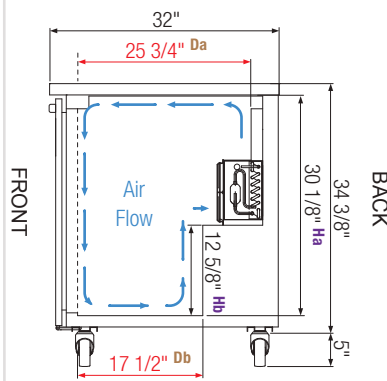

Air Flow (all models except EBB23G)

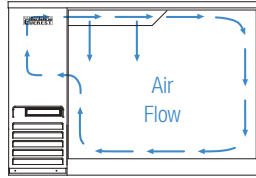

Front view of cabinet interior demonstrates air circulation from left to right.

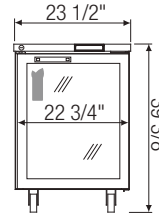

EBB23G

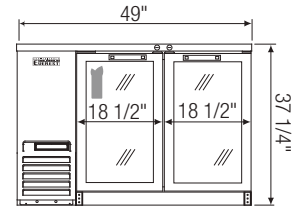

EBB48G(SS)

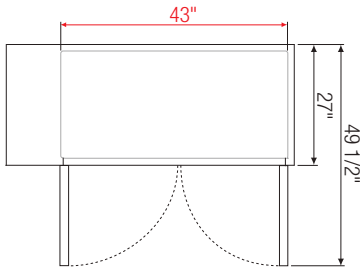

EBB59G(SS)

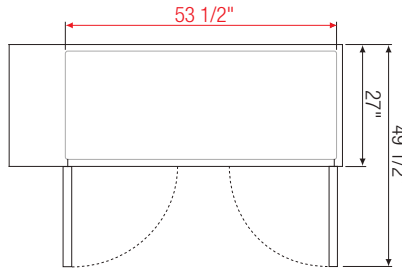

EBB69G

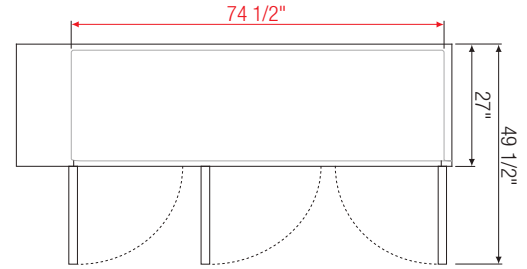

EBB90G

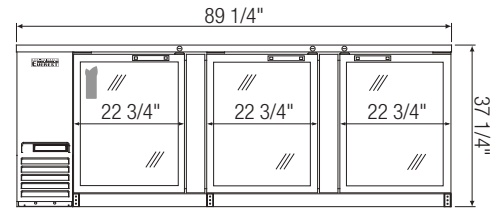
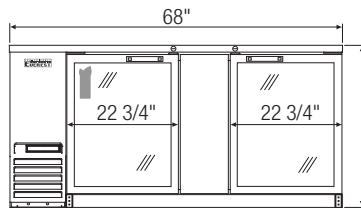
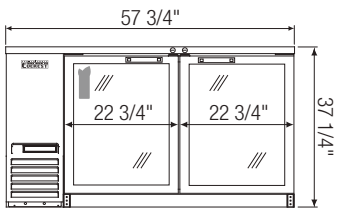

Model	Ref/ Frz/ Dual	# of Doors	Capacity (Cu. Ft.)	Capacity		HP	BTU/HR <sup>†</sup>	Refrigerant	# of Shelves	Power (V-Hz-Ph)	Amps	Crated Weight (LBS)	Exterior Dimensions (Inches)		
				12 oz. Cans	12 oz. Bottles								L	D <sup>*</sup>	H
EBB23G	Ref	1	8	220	125	1/5	1,655	R290	2	115-60-1	2.5	179	23 1/2	32	39 3/8 <sup>a</sup>
EBB48G(SS)	Ref	2	14	490	344	1/4+	1,926	R290	4	115-60-1	3.5	288	49	27	37 1/4
EBB59G(SS)	Ref	2	20	640	408	1/4+	1,926	R290	4	115-60-1	3.5	313	57 3/4	27	37 1/4
EBB69G	Ref	2	24	800	504	1/4+	1,926	R290	4	115-60-1	3.5	347	68	27	37 1/4
EBB90G	Ref	3	32	1120	696	1/3	2,311	R290	6	115-60-1	2.5	496	89 1/4	27	37 1/4

\* Depth does not include protruding door handles.

<sup>a</sup> Height includes 5" for casters.

† Based on evaporating temperature of 23°F (-5°C) & condensing temperature of 131°F (55°C).

Da, Db Interior Depth   Ha, Hb Interior Height

Specifications subject to change without notice.

Product dimensions are for general purposes and not absolute value. Product capacity (†) is calculated based on standard industry figures. Slight variations may exist. If dimensions and capacity are critical, please contact Everest Refrigeration.

Ref = Refrigerator