

# Upright Reach-Ins

## TOP MOUNTED CONDENSING UNIT (ES SERIES)

Refrigerators / Freezers / Dual Temps



The Top Mounted Upright Reach-In series offers a number of refrigerator, freezer and dual temperature combinations in solid, glass, full door, half door and drawer variations.



### Blizzard R290

EPA/DOE approved, all-in-one, slide-out cooling cartridge.



### Digital Control

Easy settings with audio and visual overheat alarm.



### ECM Fan Motors

Electronically commutated motors require less energy.

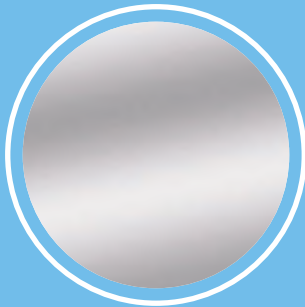

### All Stainless Steel

High quality finish with 2.5" thick thermal insulation.



### Door Lock

Pre-installed, tamper-resistant, heavy-duty tumbler.



### Vacuum Relief Valve

Equalizes cabinet pressure for smooth door re-entry.

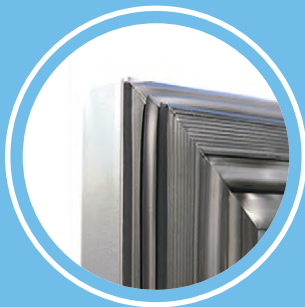

### Ridge-Lined Gasket

Heavy-duty door gaskets snap out/in for easy cleaning.

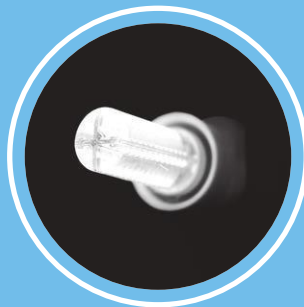

### Energy Efficient LED

Silicone coated or shielded. High lumen rating, low heat.



### Other Features

Self-closing doors, 3" or 5" swivel casters.

# Upright Reach-In Refrigerators – ES Series

## Top Mounted Condensing Unit



ESR1



ESRH2



ESR2



ESRH4



ESWR2



ESR3

## Cabinet Construction

- Heavy duty stainless steel interior / exterior with rounded corners for a hazard-free workspace.
- Open spaced interior with no walls between compartments.
- Galvanized steel top, bottom and rear.
- 2.5" thick high density polyurethane insulation.
- Four 5" swivel casters with locks on front set. Leg stabilizers standard for models ESR1, ESRH2 and ESR3.

## Refrigeration System

- Top mounted, self-contained and fully detachable Blizzard R290 condensing unit uses environmentally friendly, EPA-compliant R290 refrigerant with zero (0) Ozone Depletion Potential (ODP) and three (3) Global Warming Potential (GWP). Blizzard R290 is easily replaceable and requires no on-site brazing.
- Electronically commutated (ECM) fan motors achieve rapid cooling with less energy consumption.
- Full-length air duct and airflow guard ensure optimal cold air circulation.
- Time-initiated and temperature-terminated auto defrost cycle for seamless operation.
- Large capacity, corrosion-resistant condenser and evaporator coils.
- Self-maintaining, energy-efficient condensate drain pan requires no external drains or electric heaters.
- High performance, auto-reverse condenser fan motor supports compressor ventilation and condenser coil cleaning.
- Pressure relief devices allow rapid cabinet re-entry.
- Pre-wired and ready to plug, 115V/60Hz/1Ph, NEMA 5-15P.

## Lighting

- Energy efficient silicone coated and shatter-proof LED lighting provides bright, high color illumination with low heat output.

## Doors

- Heavy duty stainless steel interior / exterior.
- 2.5" thick high density polyurethane insulation.
- Frame heaters prevent exterior moisture build up.
- Self-closing with adjustable torsion system for a positive seal.
- Snap-in magnetic gasket for ease of cleaning.
- High strength, recessed handles.
- Pre-installed locks (does not apply to models ESRH2 and ESRH4).
- Field reversible.

## Shelving

- Epoxy coated, steel wire shelves (see table for quantity).
- Height adjustable stainless steel clips.

## Temperature Control

- Multi-function digital controller with easy to read LED display.
- Factory preset temperature, 35°F. Temp-set range from 33°F to 54°F.
- Audible overheat protection alarm for compressor and condenser coil.

## Options

- Additional shelving.
- 3" swivel casters with locks.
- 3.5" – 6" height-adjustable and interchangeable legs.
- Left hinged door (does not apply to model ESRH4).

↔ = Interior Dimensions   ← → = Exterior Dimensions

### ABS Legs



Two additional front adjustable stainless steel clad ABS legs for model ESR1 and ESRH2 provide extra stability when opening and closing doors, and one additional leg for ESR3 for weight support.

Equipped with 9 ft long NEMA 5-15P plug.

### Side View

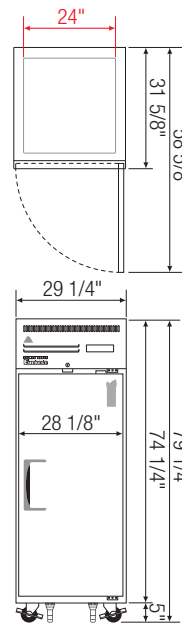
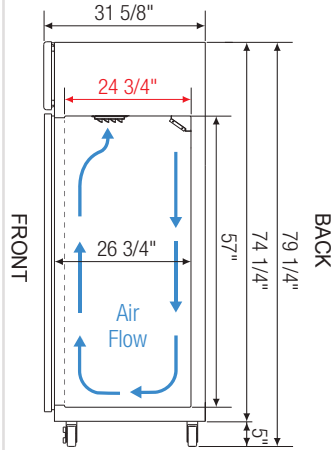

ESR1

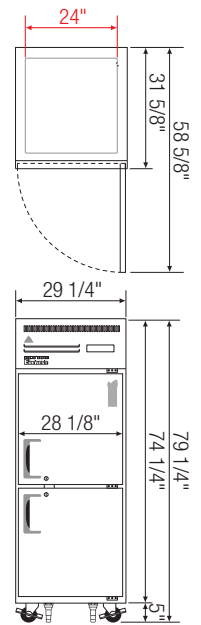

ESRH2

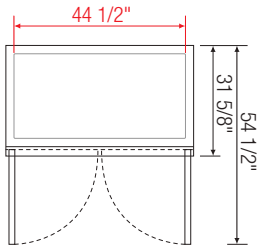

ESR2

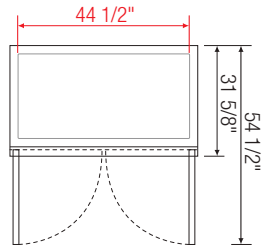

ESRH4

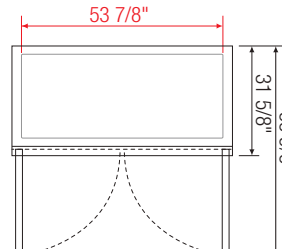

ESWR2

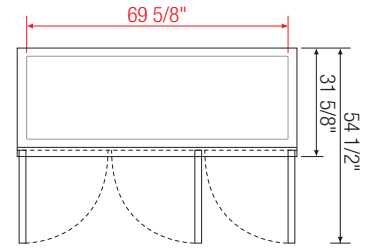

ESR3

Model	Ref/ Frz/ Dual	# of Doors	Capacity <sup>†</sup> (Cu. Ft.)	HP	BTU/HR <sup>†</sup>	Refrigerant	# of Shelves	Power (V-Hz-Ph)	Amps	Crated Weight (LBS)	Exterior Dimensions (Inches)		
											L	D	H*
ESR1	Ref	1	23	1/4+	1,926	R290	3	115-60-1	3.3	296	29 1/4	31 5/8	74 1/4
ESRH2	Ref	2 (H)	23	1/4+	1,926	R290	3	115-60-1	3.3	298	29 1/4	31 5/8	74 1/4
ESR2	Ref	2	48	1/4+	1,926	R290	6	115-60-1	3.8	401	49 5/8	31 5/8	74 1/4
ESRH4	Ref	4 (H)	48	1/4+	1,926	R290	6	115-60-1	3.8	404	49 5/8	31 5/8	74 1/4
ESWR2	Ref	2	55	1/3	2,311	R290	6	115-60-1	3	456	59	31 5/8	74 1/4
ESR3	Ref	3	71	3/4	4,445	R290	8	115-60-1	8	576	74 3/4	31 5/8	74 1/4

\* Height does not include 5" for casters.

Ref = Refrigerator | (H) = Half Door

† Based on evaporating temperature of 23°F (-5°C) & condensing temperature of 131°F (55°C).

Specifications subject to change without notice.

Product dimensions are for general purposes and not absolute value. Product capacity (†) is calculated based on standard industry figures. Slight variations may exist. If dimensions and capacity are critical, please contact Everest Refrigeration.