



# STAINLESS STEEL FABRICATED ECONOMY SINKS



## One & Two Compartments



Item #: \_\_\_\_\_ Qty #: \_\_\_\_\_

Model #: \_\_\_\_\_

Project #: \_\_\_\_\_

Rolled Rim Edge  
For Additional Strength

### MATERIAL:

1 5/8" diameter stainless steel legs with  
1" adjustable stainless steel bullet feet.

Entire unit is 16 gauge 304 stainless steel.

Gussets - stainless steel.

### MECHANICAL:

- Supply is 1/2" IPS hot & cold.
- Faucet holes on 8" centers.
- Faucets are not included  
(see accessories).
- Waste drains are 1 1/2" IPS S/S basket  
type, located in center of sink bowl, and are  
included.

### FEATURES:

Backsplash has tile edge for ease  
of installation.

Sink bowls are 3/4" coved corner and meet  
NSF requirements.

Rolled Rim Edge for additional strength.

Sink Bowls are 14" deep for greater capacity.

### CONSTRUCTION:

All TIG welded.

Welded areas blended to match adjacent  
surfaces and to a satin finish.

Gussets welded to a die-formed  
reinforced plate.

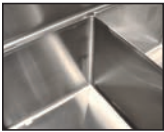

Fabricated Bowls are  
Welded Together at the  
Seams

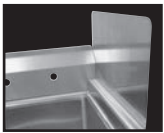

**K-700**  
Removable  
Side Splashes  
Fits Left OR Right  
Side

| MODEL #                 | Length<br>L | Width<br>W | Bowl Size<br>A & B | Drbd. Length<br>C | # of<br>Drbds. | Drbd.<br>Location | Wt       |
|-------------------------|-------------|------------|--------------------|-------------------|----------------|-------------------|----------|
| <b>FC-1-1620</b>        | 21"         | 26"        | <b>16" x 20"</b>   | N/A               | 0              | None              | 50 lbs.  |
| <b>FC-1-1620-18RorL</b> | 36 1/2"     | 26"        |                    | 18"               | 1              | Specify           | 65 lbs.  |
| <b>FC-1-1620-18RL</b>   | 52"         | 26"        |                    | 18"               | 2              | R & L             | 80 lbs.  |
| <b>FC-1-1818</b>        | 23"         | 24"        | <b>18" x 18"</b>   | N/A               | 0              | None              | 60 lbs.  |
| <b>FC-1-1818-18RorL</b> | 38 1/2"     | 24"        |                    | 18"               | 1              | Specify           | 65 lbs.  |
| <b>FC-1-1818-24RorL</b> | 44 1/2"     | 24"        |                    | 24"               | 1              | Specify           | 70 lbs.  |
| <b>FC-1-1818-18RL</b>   | 54"         | 24"        |                    | 18"               | 2              | R & L             | 90 lbs.  |
| <b>FC-1-1818-24RL</b>   | 66"         | 24"        |                    | 24"               | 2              | R & L             | 100 lbs. |
| <b>FC-1-1824</b>        | 23"         | 30"        | <b>18" x 24"</b>   | N/A               | 0              | None              | 67 lbs.  |
| <b>FC-1-1824-18RorL</b> | 38 1/2"     | 30"        |                    | 18"               | 1              | Specify           | 105 lbs. |
| <b>FC-1-1824-24RorL</b> | 45"         | 30"        |                    | 24"               | 1              | Specify           | 115 lbs. |
| <b>FC-1-1824-18RL</b>   | 54"         | 30"        |                    | 18"               | 2              | R & L             | 120 lbs. |
| <b>FC-1-1824-24RL</b>   | 66"         | 30"        |                    | 24"               | 2              | R & L             | 130 lbs. |
| <b>FC-1-2424</b>        | 29"         | 30"        | <b>24" x 24"</b>   | N/A               | 0              | None              | 90 lbs.  |
| <b>FC-1-2424-18RorL</b> | 45"         | 30"        |                    | 18"               | 1              | Specify           | 118 lbs. |
| <b>FC-1-2424-24RorL</b> | 50 1/2"     | 30"        |                    | 24"               | 1              | Specify           | 123 lbs. |
| <b>FC-1-2424-18RL</b>   | 60"         | 30"        | 18"                | 2                 | R & L          | 135 lbs.          |          |
| <b>FC-1-2424-24RL</b>   | 72"         | 30"        | 24"                | 2                 | R & L          | 145 lbs.          |          |
| <b>FC-1-3024</b>        | 35"         | 30"        | <b>30" x 24"</b>   | N/A               | 0              | None              | 80 lbs.  |
| <b>FC-1-3024-24RorL</b> | 56 1/2"     | 30"        |                    | 24"               | 1              | Specify           | 180 lbs. |
| <b>FC-1-3024-24RL</b>   | 78"         | 30"        |                    | 24"               | 2              | R & L             | 225 lbs. |
| <b>FC-1-3624</b>        | 41"         | 30"        | <b>36" x 24"</b>   | N/A               | 0              | None              | 200 lbs. |
| <b>FC-1-3624-24RorL</b> | 62 1/2"     | 30"        |                    | 24"               | 1              | Specify           | 225 lbs. |
| <b>FC-1-3624-24RL</b>   | 84"         | 30"        |                    | 24"               | 2              | R & L             | 250 lbs. |
| <b>FC-1-4824-24RL</b>   | 96"         | 30"        | <b>48" x 24"</b>   | 24"               | 2              | R & L             | 290 lbs. |
| <b>FC-2-1515</b>        | 35"         | 21"        | <b>15" x 15"</b>   | N/A               | 0              | None              | 78 lbs.  |
| <b>FC-2-1620</b>        | 37"         | 26"        | <b>16" x 20"</b>   | N/A               | 0              | None              | 85 lbs.  |
| <b>FC-2-1620-18RorL</b> | 52 1/2"     | 26"        |                    | 18"               | 1              | Specify           | 100 lbs. |
| <b>FC-2-1620-18RL</b>   | 68"         | 26"        |                    | 18"               | 2              | R & L             | 118 lbs. |
| <b>FC-2-1818</b>        | 41"         | 24"        | <b>18" x 18"</b>   | N/A               | 0              | None              | 83 lbs.  |
| <b>FC-2-1818-18RorL</b> | 56 1/2"     | 24"        |                    | 18"               | 1              | Specify           | 90 lbs.  |
| <b>FC-2-1818-18RL</b>   | 72"         | 24"        |                    | 18"               | 2              | R & L             | 105 lbs. |
| <b>FC-2-1818-24RL</b>   | 84"         | 24"        |                    | 24"               | 2              | R & L             | 115 lbs. |
| <b>FC-2-1824</b>        | 41"         | 30"        | <b>18" x 24"</b>   | N/A               | 0              | None              | 115 lbs. |
| <b>FC-2-1824-18RorL</b> | 56 1/2"     | 30"        |                    | 18"               | 1              | Specify           | 130 lbs. |
| <b>FC-2-1824-24RorL</b> | 62 1/2"     | 30"        |                    | 24"               | 1              | Specify           | 140 lbs. |
| <b>FC-2-1824-18RL</b>   | 72"         | 30"        |                    | 18"               | 2              | R & L             | 145 lbs. |
| <b>FC-2-1824-24RL</b>   | 84"         | 30"        |                    | 24"               | 2              | R & L             | 160 lbs. |
| <b>FC-2-2424</b>        | 53"         | 30"        | <b>24" x 24"</b>   | N/A               | 0              | None              | 138 lbs. |
| <b>FC-2-2424-18RorL</b> | 68 1/2"     | 30"        |                    | 18"               | 1              | Specify           | 155 lbs. |
| <b>FC-2-2424-18RL</b>   | 84"         | 30"        |                    | 18"               | 2              | R & L             | 210 lbs. |
| <b>FC-2-2424-24RorL</b> | 74 1/2"     | 30"        |                    | 24"               | 1              | Specify           | 195 lbs. |
| <b>FC-2-2424-24RL</b>   | 96"         | 30"        |                    | 24"               | 2              | R & L             | 225 lbs. |



Customer Service Available To Assist You **1-800-645-3166** 8:30 am - 8:00 pm E.S.T.

For Orders & Customer Service:

Email: [customer@advancetabco.com](mailto:customer@advancetabco.com) or Fax: 631-242-6900

For Smart Fabrication™ Quotes:

Email: [smartfab@advancetabco.com](mailto:smartfab@advancetabco.com) or Fax: 631-586-2933

# DIMENSIONS and SPECIFICATIONS

TOL Overall:  $\pm .500''$   
 Interior:  $\pm .250''$

ALL DIMENSIONS ARE TYPICAL

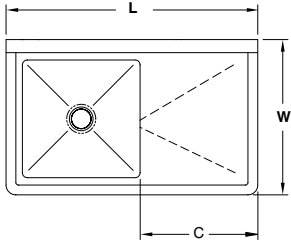

**1 COMP - 1 DRBD**

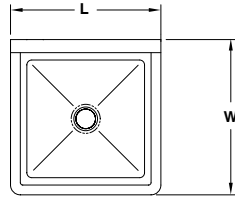

**1 COMP**

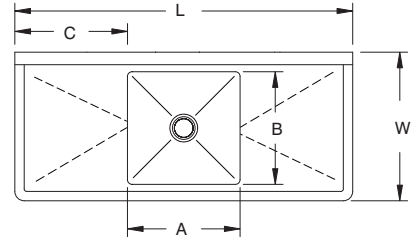

**1 COMP - 2 DRBDS**

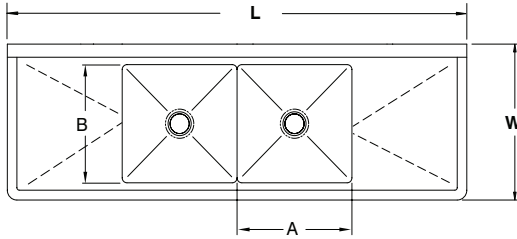

**2 COMP - 2 DRBD**

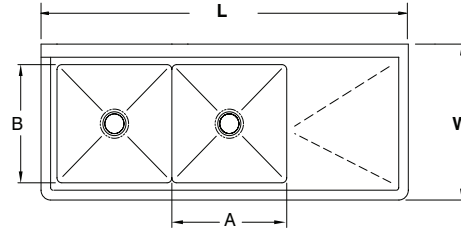

**2 COMP - 1 DRBD**

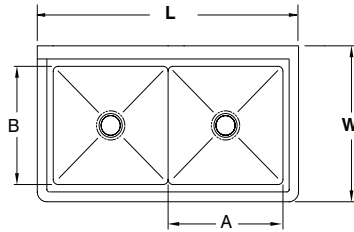

**2 COMP**

| ACCESSORIES | Model # | Qty |
|-------------|---------|-----|
| DRAINS      |         |     |
| FAUCETS     |         |     |

