



# STAINLESS STEEL ECONOMY STAINLESS STEEL WORK TABLES



Stainless Steel Bullet Feet are standard on SLAG, SFLAG & KSLAG Series



Item #: \_\_\_\_\_ Qty #: \_\_\_\_\_  
 Model #: \_\_\_\_\_  
 Project #: \_\_\_\_\_

### FEATURES:

**SLAG** Top is furnished with 1 5/8" sanitary rolled rim on front and rear & square ends.

**SFLAG** Top is furnished with 1 5/8" sanitary rolled rim on front and square ends, and 1 1/2" backsplash on rear.

**KSLAG** Top is furnished with 1 5/8" sanitary rolled rim on front and square ends, and 5" backsplash on rear.

Two hat-channels stud welded under tabletop to reinforce and maintain a level work surface.

Aluminum die cast "leg-to-shelf" clamp secures shelf to leg eliminating unsightly nuts and bolts. Undershaft is fully adjustable.

### CONSTRUCTION:

All TIG welded. Exposed weld areas polished to match adjacent surface.

Top is sound deadened.

Roll formed embossed galvanized hat channels are secured to top by means of structural adhesive and weld studs.

Gussets welded to support hat channels.

### MATERIAL:

**TOP:** 16 gauge stainless steel type "430" series.

**SHELF:** 18 gauge stainless steel.

**LEGS:** 1 5/8" diameter tubular stainless steel. Stainless steel gussets. 1" adjustable stainless steel bullet feet.



**FLAT TOP**  
SLAG-X Series



**1-1/2" BACKSPASH**  
SFLAG-X Series



**5" BACKSPASH**  
KSLAG-X Series

	L	Model #	WT.	Cu.		WT.	Cu.		WT.	Cu.	
				Ft.	Ft.		Ft.	Ft.		Ft.	Ft.
				<b>FLAT TOP</b>			<b>1 1/2" SPLASH</b>			<b>5" SPLASH</b>	
<b>18" WIDE</b>	24"	SLAG-182-X	37 lbs.	4	-	-	-	-	-	-	-
	30"	SLAG-180-X	44 lbs.	4	-	-	-	-	-	-	-
	36"	SLAG-183-X	47 lbs.	4	-	-	-	-	-	-	-
	48"	SLAG-184-X	58 lbs.	5	-	-	-	-	-	-	-
	60"	SLAG-185-X	66 lbs.	7	-	-	-	-	-	-	-
	72"	SLAG-186-X	79 lbs.	8	-	-	-	-	-	-	-
<b>24" WIDE</b>	24"	SLAG-242-X	44 lbs.	4	SFLAG-242-X	44 lbs.	4	KSLAG-242-X	48 lbs.	7	7
	30"	SLAG-240-X	50 lbs.	4	SFLAG-240-X	50 lbs.	4	KSLAG-240-X	55 lbs.	7	7
	36"	SLAG-243-X	56 lbs.	4	SFLAG-243-X	56 lbs.	4	KSLAG-243-X	61 lbs.	7	7
	48"	SLAG-244-X	69 lbs.	6	SFLAG-244-X	69 lbs.	6	KSLAG-244-X	75 lbs.	9	9
	60"	SLAG-245-X	80 lbs.	7	SFLAG-245-X	80 lbs.	7	KSLAG-245-X	89 lbs.	11	11
	72"	SLAG-246-X	95 lbs.	8	SFLAG-246-X	95 lbs.	8	KSLAG-246-X	102 lbs.	13	13
	84"	SLAG-247-X	108 lbs.	10	SFLAG-247-X	108 lbs.	10	KSLAG-247-X	117 lbs.	15	15
	96"	SLAG-248-X*	128 lbs.	11	SFLAG-248-X*	128 lbs.	11	KSLAG-248-X*	137 lbs.	17	17
<b>30" WIDE</b>	24"	SLAG-302-X	49 lbs.	5	SFLAG-302-X	49 lbs.	5	KSLAG-302-X	53 lbs.	8	8
	30"	SLAG-300-X	56 lbs.	5	SFLAG-300-X	56 lbs.	5	KSLAG-300-X	61 lbs.	8	8
	36"	SLAG-303-X	64 lbs.	5	SFLAG-303-X	64 lbs.	5	KSLAG-303-X	69 lbs.	8	8
	48"	SLAG-304-X	79 lbs.	7	SFLAG-304-X	79 lbs.	7	KSLAG-304-X	84 lbs.	11	11
	60"	SLAG-305-X	95 lbs.	8	SFLAG-305-X	95 lbs.	8	KSLAG-305-X	101 lbs.	13	13
	72"	SLAG-306-X	110 lbs.	10	SFLAG-306-X	110 lbs.	10	KSLAG-306-X	117 lbs.	16	16
	84"	SLAG-307-X	125 lbs.	12	SFLAG-307-X	125 lbs.	12	KSLAG-307-X	133 lbs.	18	18
	96"	SLAG-308-X*	148 lbs.	13	SFLAG-308-X*	148 lbs.	13	KSLAG-308-X*	158 lbs.	20	20
<b>36" WIDE</b>	36"	SLAG-363-X	73 lbs.	6	SFLAG-363-X	73 lbs.	6	-	-	-	-
	48"	SLAG-364-X	92 lbs.	8	SFLAG-364-X	92 lbs.	8	-	-	-	-
	60"	SLAG-365-X	111 lbs.	10	SFLAG-365-X	111 lbs.	10	-	-	-	-
	72"	SLAG-366-X	130 lbs.	12	SFLAG-366-X	130 lbs.	12	-	-	-	-
	96"	SLAG-368-X*	176 lbs.	15	SFLAG-368-X*	176 lbs.	15	-	-	-	-

All 8 ft. Tables Provided With 6 Legs



Customer Service Available To Assist You **1-800-645-3166** 8:30 am - 7:00 pm E.S.T.

For Orders & Customer Service:

Email: customer@advancetabco.com or Fax: 631-242-6900

For Smart Fabrication™ Quotes:

Email: smartfab@advancetabco.com or Fax: 631-586-2933

# DETAILS and SPECIFICATIONS

TOL  $\pm$  .500"

ALL DIMENSIONS ARE TYPICAL

## SLAG SERIES - Flat Top

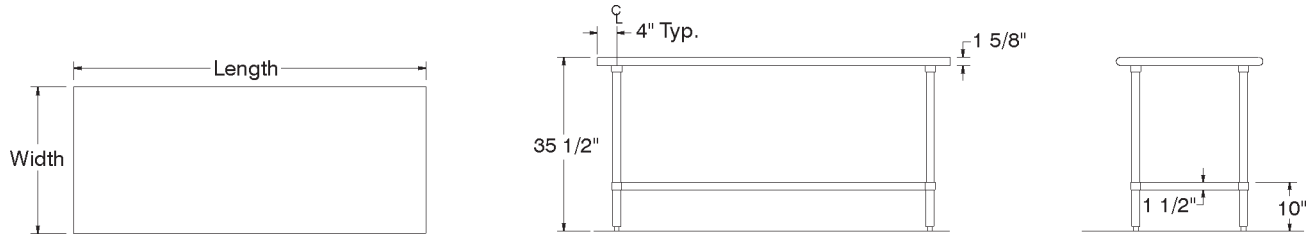

## SFLAG SERIES - 1 1/2" Backsplash

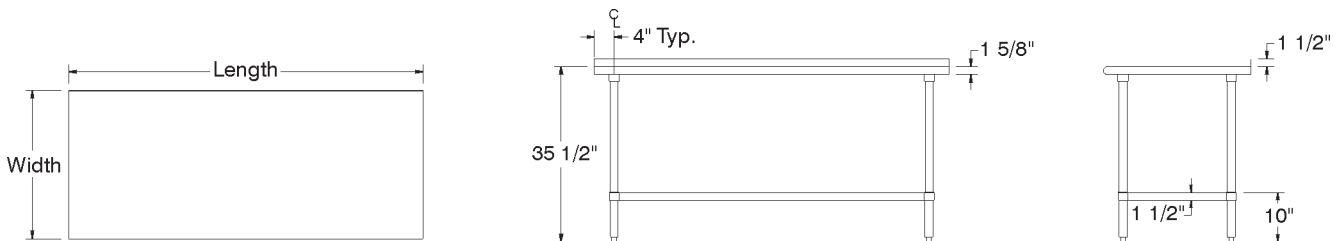

## KSLAG SERIES- 5" Backsplash

