



# STAINLESS STEEL FABRICATED ECONOMY SINKS



## One & Two Compartments



Item #: \_\_\_\_\_ Qty #: \_\_\_\_\_  
 Model #: \_\_\_\_\_  
 Project #: \_\_\_\_\_

Rolled Rim Edge  
For Additional Strength

### MATERIAL:

1 5/8" diameter stainless steel legs with 1" adjustable stainless steel bullet feet.

Entire unit is 16 gauge 304 stainless steel.

Gussets - stainless steel.

### MECHANICAL:

- Supply is 1/2" IPS hot & cold.
- Faucet holes on 8" centers.
- Faucets are not included (see accessories).
- Waste drains are 1 1/2" IPS S/S basket type, located in center of sink bowl, and are included.

### FEATURES:

Backsplash has tile edge for ease of installation.

Sink bowls are 3/4" coved corner and meet NSF requirements.

Rolled Rim Edge for additional strength.

Sink Bowls are 14" deep for greater capacity.

### CONSTRUCTION:

All TIG welded.

Welded areas blended to match adjacent surfaces and to a satin finish.

Gussets welded to a die-formed reinforced plate.

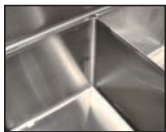

Fabricated Bowls are Welded Together at the Seams



### K-700

Removable Side Splashes  
Fits Left OR Right Side

| MODEL #                 | Length L | Width W | Bowl Size A & B  | Drbd. Length C | # of Drbds. | Drbd. Location | Wt       |
|-------------------------|----------|---------|------------------|----------------|-------------|----------------|----------|
| <b>FC-1-1620</b>        | 21"      | 26"     | <b>16" x 20"</b> | N/A            | 0           | None           | 50 lbs.  |
| <b>FC-1-1620-18RorL</b> | 36 1/2"  | 26"     |                  | 18"            | 1           | Specify        | 65 lbs.  |
| <b>FC-1-1620-18RL</b>   | 52"      | 26"     |                  | 18"            | 2           | R & L          | 80 lbs.  |
| <b>FC-1-1818</b>        | 23"      | 24"     | <b>18" x 18"</b> | N/A            | 0           | None           | 60 lbs.  |
| <b>FC-1-1818-18RorL</b> | 38 1/2"  | 24"     |                  | 18"            | 1           | Specify        | 65 lbs.  |
| <b>FC-1-1818-24RorL</b> | 44 1/2"  | 24"     |                  | 24"            | 1           | Specify        | 70 lbs.  |
| <b>FC-1-1818-18RL</b>   | 54"      | 24"     |                  | 18"            | 2           | R & L          | 90 lbs.  |
| <b>FC-1-1818-24RL</b>   | 66"      | 24"     |                  | 24"            | 2           | R & L          | 100 lbs. |
| <b>FC-1-1824</b>        | 23"      | 30"     | <b>18" x 24"</b> | N/A            | 0           | None           | 67 lbs.  |
| <b>FC-1-1824-18RorL</b> | 38 1/2"  | 30"     |                  | 18"            | 1           | Specify        | 105 lbs. |
| <b>FC-1-1824-24RorL</b> | 45"      | 30"     |                  | 24"            | 1           | Specify        | 115 lbs. |
| <b>FC-1-1824-18RL</b>   | 54"      | 30"     |                  | 18"            | 2           | R & L          | 120 lbs. |
| <b>FC-1-1824-24RL</b>   | 66"      | 30"     |                  | 24"            | 2           | R & L          | 130 lbs. |
| <b>FC-1-2424</b>        | 29"      | 30"     | <b>24" x 24"</b> | N/A            | 0           | None           | 90 lbs.  |
| <b>FC-1-2424-18RorL</b> | 45"      | 30"     |                  | 18"            | 1           | Specify        | 118 lbs. |
| <b>FC-1-2424-24RorL</b> | 50 1/2"  | 30"     |                  | 24"            | 1           | Specify        | 123 lbs. |
| <b>FC-1-2424-18RL</b>   | 60"      | 30"     | 18"              | 2              | R & L       | 135 lbs.       |          |
| <b>FC-1-2424-24RL</b>   | 72"      | 30"     | 24"              | 2              | R & L       | 145 lbs.       |          |
| <b>FC-1-3024</b>        | 35"      | 30"     | <b>30" x 24"</b> | N/A            | 0           | None           | 80 lbs.  |
| <b>FC-1-3024-24RorL</b> | 56 1/2"  | 30"     |                  | 24"            | 1           | Specify        | 180 lbs. |
| <b>FC-1-3024-24RL</b>   | 78"      | 30"     |                  | 24"            | 2           | R & L          | 225 lbs. |
| <b>FC-1-3624</b>        | 41"      | 30"     | <b>36" x 24"</b> | N/A            | 0           | None           | 200 lbs. |
| <b>FC-1-3624-24RorL</b> | 62 1/2"  | 30"     |                  | 24"            | 1           | Specify        | 225 lbs. |
| <b>FC-1-3624-24RL</b>   | 84"      | 30"     |                  | 24"            | 2           | R & L          | 250 lbs. |
| <b>FC-1-4824-24RL</b>   | 96"      | 30"     | <b>48" x 24"</b> | 24"            | 2           | R & L          | 290 lbs. |
| <b>FC-2-1515</b>        | 35"      | 21"     | <b>15" x 15"</b> | N/A            | 0           | None           | 78 lbs.  |
| <b>FC-2-1620</b>        | 37"      | 26"     | <b>16" x 20"</b> | N/A            | 0           | None           | 85 lbs.  |
| <b>FC-2-1620-18RorL</b> | 52 1/2"  | 26"     |                  | 18"            | 1           | Specify        | 100 lbs. |
| <b>FC-2-1620-18RL</b>   | 68"      | 26"     |                  | 18"            | 2           | R & L          | 118 lbs. |
| <b>FC-2-1818</b>        | 41"      | 24"     | <b>18" x 18"</b> | N/A            | 0           | None           | 83 lbs.  |
| <b>FC-2-1818-18RorL</b> | 56 1/2"  | 24"     |                  | 18"            | 1           | Specify        | 90 lbs.  |
| <b>FC-2-1818-18RL</b>   | 72"      | 24"     |                  | 18"            | 2           | R & L          | 105 lbs. |
| <b>FC-2-1818-24RL</b>   | 84"      | 24"     |                  | 24"            | 2           | R & L          | 115 lbs. |
| <b>FC-2-1824</b>        | 41"      | 30"     | <b>18" x 24"</b> | N/A            | 0           | None           | 115 lbs. |
| <b>FC-2-1824-18RorL</b> | 56 1/2"  | 30"     |                  | 18"            | 1           | Specify        | 130 lbs. |
| <b>FC-2-1824-24RorL</b> | 62 1/2"  | 30"     |                  | 24"            | 1           | Specify        | 140 lbs. |
| <b>FC-2-1824-18RL</b>   | 72"      | 30"     |                  | 18"            | 2           | R & L          | 145 lbs. |
| <b>FC-2-1824-24RL</b>   | 84"      | 30"     |                  | 24"            | 2           | R & L          | 160 lbs. |
| <b>FC-2-2424</b>        | 53"      | 30"     | <b>24" x 24"</b> | N/A            | 0           | None           | 138 lbs. |
| <b>FC-2-2424-18RorL</b> | 68 1/2"  | 30"     |                  | 18"            | 1           | Specify        | 155 lbs. |
| <b>FC-2-2424-18RL</b>   | 84"      | 30"     |                  | 18"            | 2           | R & L          | 210 lbs. |
| <b>FC-2-2424-24RorL</b> | 74 1/2"  | 30"     |                  | 24"            | 1           | Specify        | 195 lbs. |
| <b>FC-2-2424-24RL</b>   | 96"      | 30"     |                  | 24"            | 2           | R & L          | 225 lbs. |



Customer Service Available To Assist You 1-800-645-3166 8:30 am - 8:00 pm E.S.T.

For Orders & Customer Service:

Email: customer@advancetabco.com or Fax: 631-242-6900

For Smart Fabrication™ Quotes:

Email: smartfab@advancetabco.com or Fax: 631-586-2933

# DIMENSIONS and SPECIFICATIONS

TOL Overall:  $\pm .500''$   
 Interior:  $\pm .250''$

ALL DIMENSIONS ARE TYPICAL

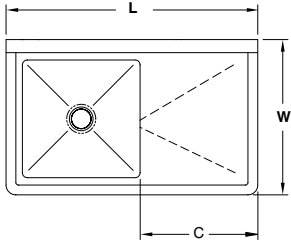

**1 COMP - 1 DRBD**

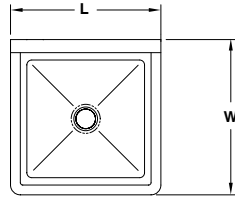

**1 COMP**

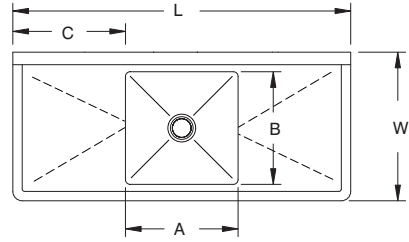

**1 COMP - 2 DRBDS**

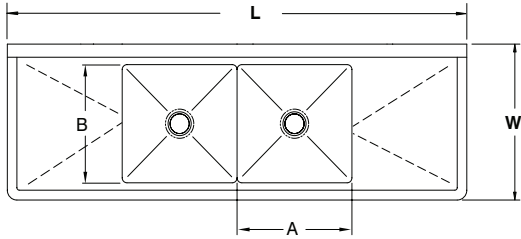

**2 COMP - 2 DRBD**

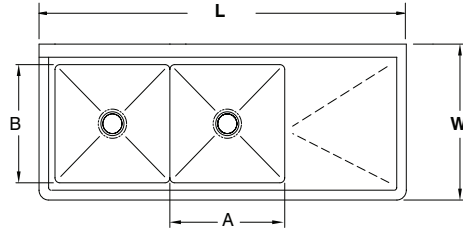

**2 COMP - 1 DRBD**

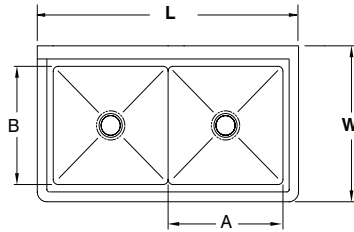

**2 COMP**

| ACCESSORIES | Model # | Qty |
|-------------|---------|-----|
| DRAINS      |         |     |
| FAUCETS     |         |     |
|             |         |     |

